

A

B

C

D

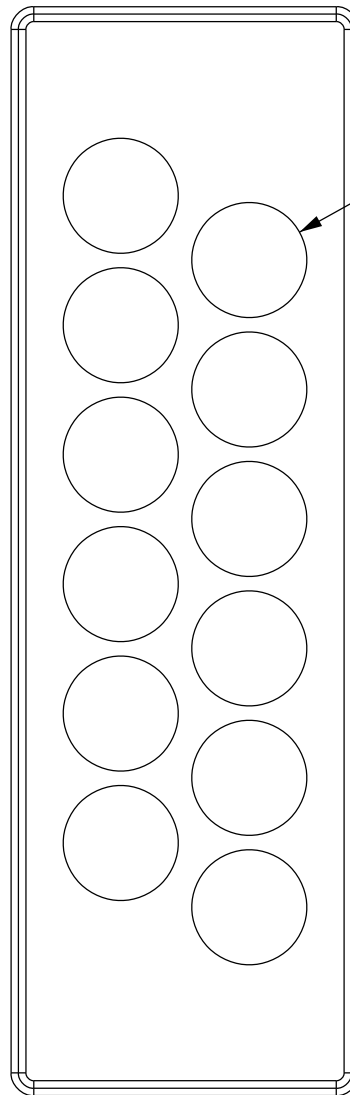
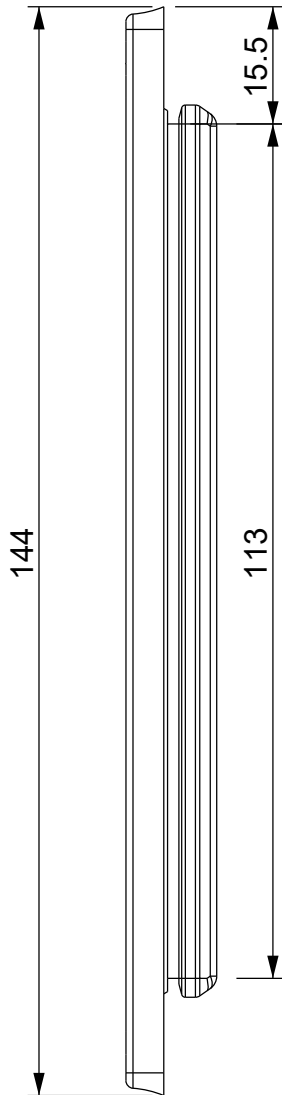
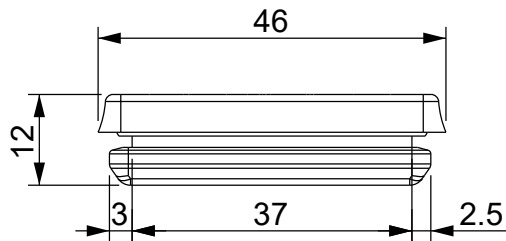
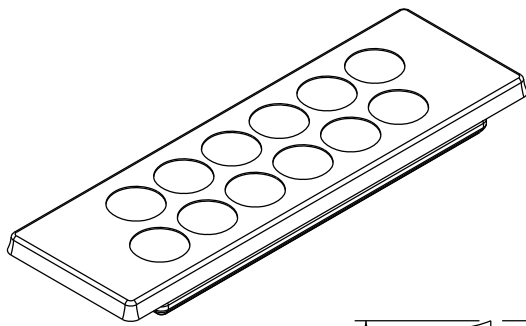

12x max Ø15

Versione colore NERO:
DES PM 24/12B 1732053413

Spessore parete: 1.5 - 2.5 mm

Infiammabilità: UL94-V0, autoestinguente
Temperatura: -40°C ... +105°C
Proprietà: senza alogeni, senza siliceni
Materiale: elastomero termoplastico (TPE)

Apertura consigliata:
112 x 36 mm

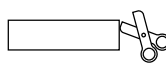

IP65

NEMA
12UL TYPE
12

ECOLAB



UL94-V0

UV
ISO 4892-2ARoHS
COMPLIANT

Codice / Code

1732052412

Descrizione / Description

DES PM 24/12 G

Rev.

004

Materiale / Material

TPE

Colore / Color

Grigio

Peso / Weight (g)

-

Unità di misura / Measure units

mm

Formato / Format

A4

Scala / Scale

1:1

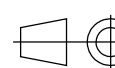
UNI-ISO
2768-mk

www.detasultra.com

Data / Date

10/12/2021

Numero foglio / Sheet number

-

Numero progetto / Project number

-

Disegn. / Drawn

ravezzano@detas.com

Note / Notes

-

QUESTO DISEGNO E LE SUE INFORMAZIONI SONO STRETTAMENTE RISERVATE DI PROPRIETA' DETAS SPA.
NON UTILIZZARE PER SCOPI DIVERSI DA QUELLI PER CUI SONO STATE FORNITE. DO NOT SCALE DRAWING.

A

B

C

D

A

B

C

D

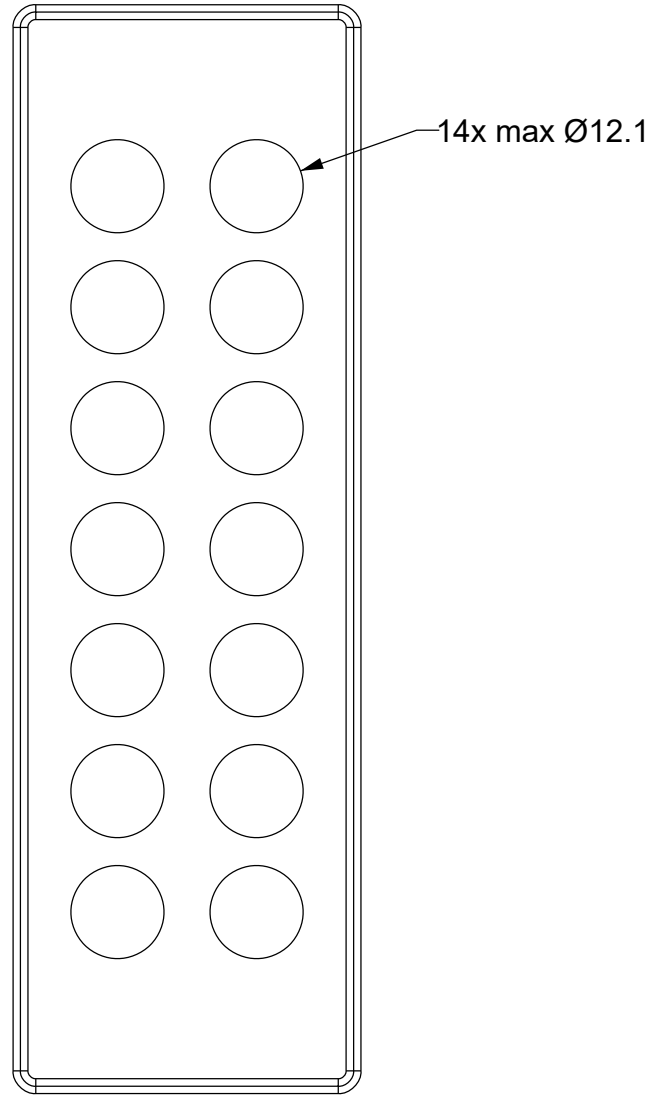
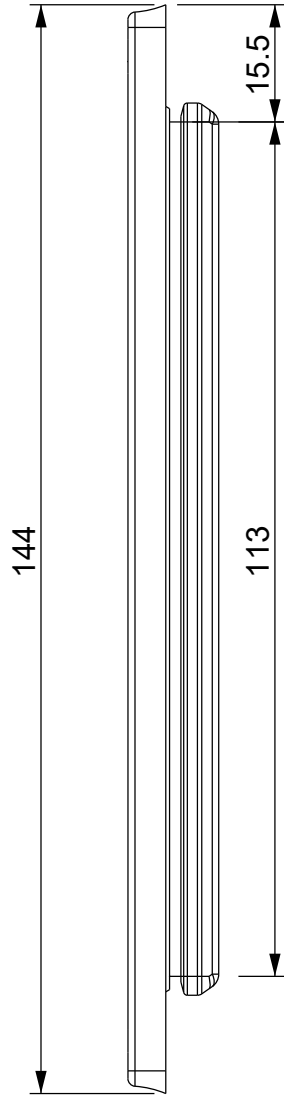
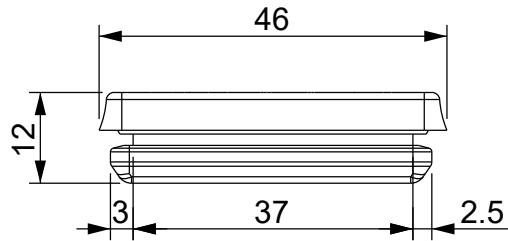
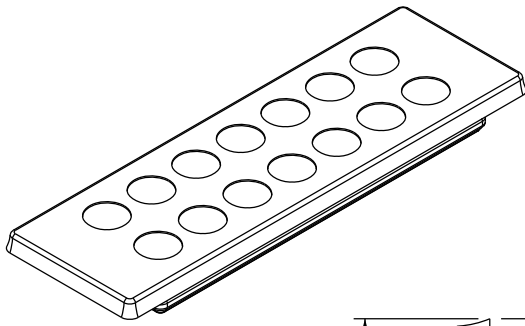

Versione colore NERO:
DES PM 24/14B 1732053415

Spessore parete: 1.5 - 2.5 mm

Infiammabilità: UL94-V0, autoestinguente
Temperatura: -40°C ... +105°C
Proprietà: senza alogeni, senza siliceni
Materiale: elastomero termoplastico (TPE)

Apertura consigliata:
112 x 36 mm

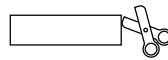

IP65

NEMA
12

UL TYPE
12



ECOLAB



UL94-V0



UV
ISO 4892-2A



RoHS
COMPLIANT

Codice / Code

1732052414

Descrizione / Description

DES PM 24/14 G

Rev.
004

Materiale / Material

TPE

Colore / Color

Grigio

Peso / Weight (g)

-

Unità di misura / Measure units

mm

Formato / Format

A4

Scala / Scale

1:1

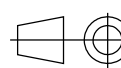

UNI-ISO
2768-mk



Data / Date
10/12/2021

Numero foglio / Sheet number

-

Numero progetto / Project number

-

Disegn. / Drawn
ravezzano@detas.com

Note / Notes

-

QUESTO DISEGNO E LE SUE INFORMAZIONI SONO STRETTAMENTE RISERVATE DI PROPRIETA' DETAS SPA.
NON UTILIZZARE PER SCOPI DIVERSI DA QUELLI PER CUI SONO STATE FORNITE. DO NOT SCALE DRAWING.

A

B

C

D

A

B

C

D

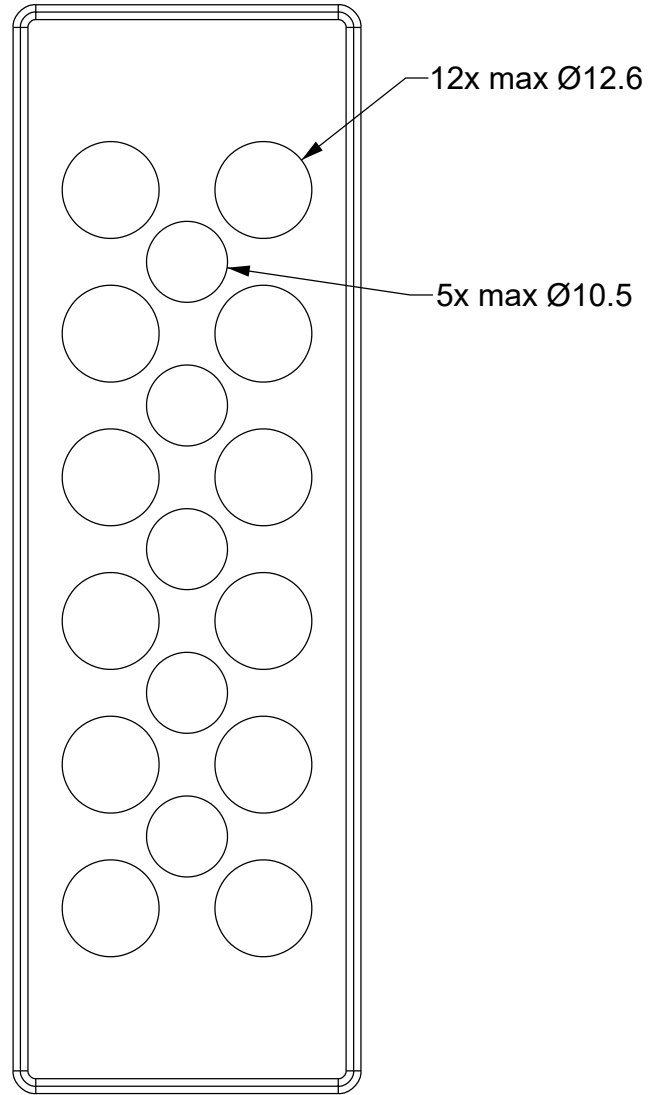
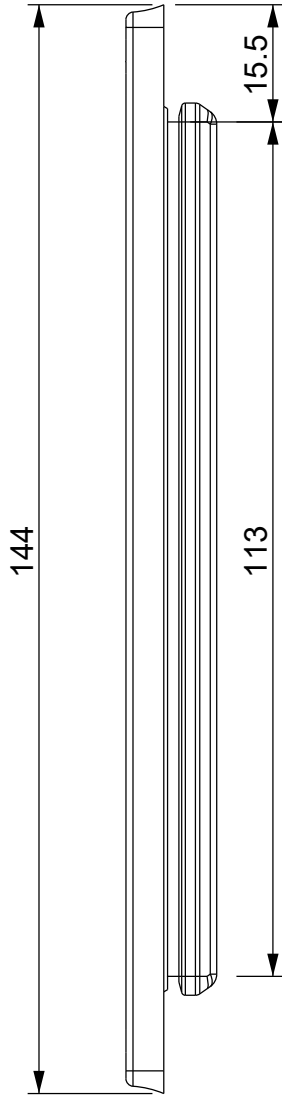
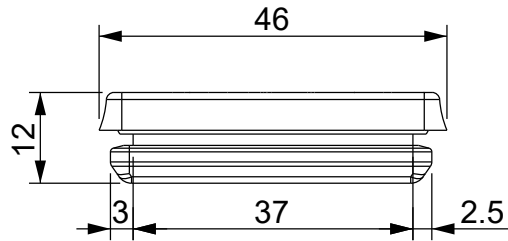
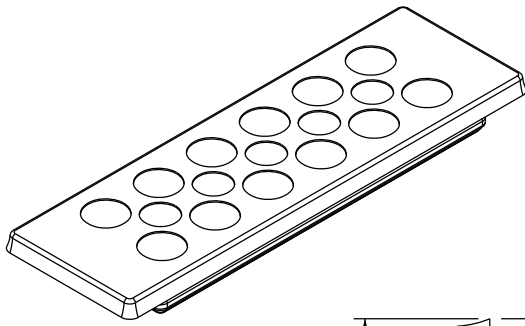

Versione colore NERO:
DES PM 24/17B 1732053418

Spessore parete: 1.5 - 2.5 mm

Infiammabilità: UL94-V0, autoestinguente
Temperatura: -40°C ... +105°C
Proprietà: senza alogeni, senza siliceni
Materiale: elastomero termoplastico (TPE)

Apertura consigliata:
112 x 36 mm

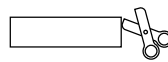

IP65

NEMA
12

UL TYPE
12



ECOLAB



UL94-V0



UV
ISO 4892-2A



RoHS
COMPLIANT

Codice / Code

1732052417

Descrizione / Description

DES PM 24/17 G

Rev.
004

Materiale / Material

TPE

Colore / Color

Grigio

Peso / Weight (g)

-

Unità di misura / Measure units

mm

Formato / Format

A4

Scala / Scale

1:1

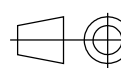

UNI-ISO
2768-mk



Data / Date
10/12/2021

Numero foglio / Sheet number

-

Numero progetto / Project number

-

Disegn. / Drawn
ravezzano@detas.com

Note / Notes

-

QUESTO DISEGNO E LE SUE INFORMAZIONI SONO STRETTAMENTE RISERVATE DI PROPRIETA' DETAS SPA.
NON UTILIZZARE PER SCOPI DIVERSI DA QUELLI PER CUI SONO STATE FORNITE. DO NOT SCALE DRAWING.

A

B

C

D

A

B

C

D

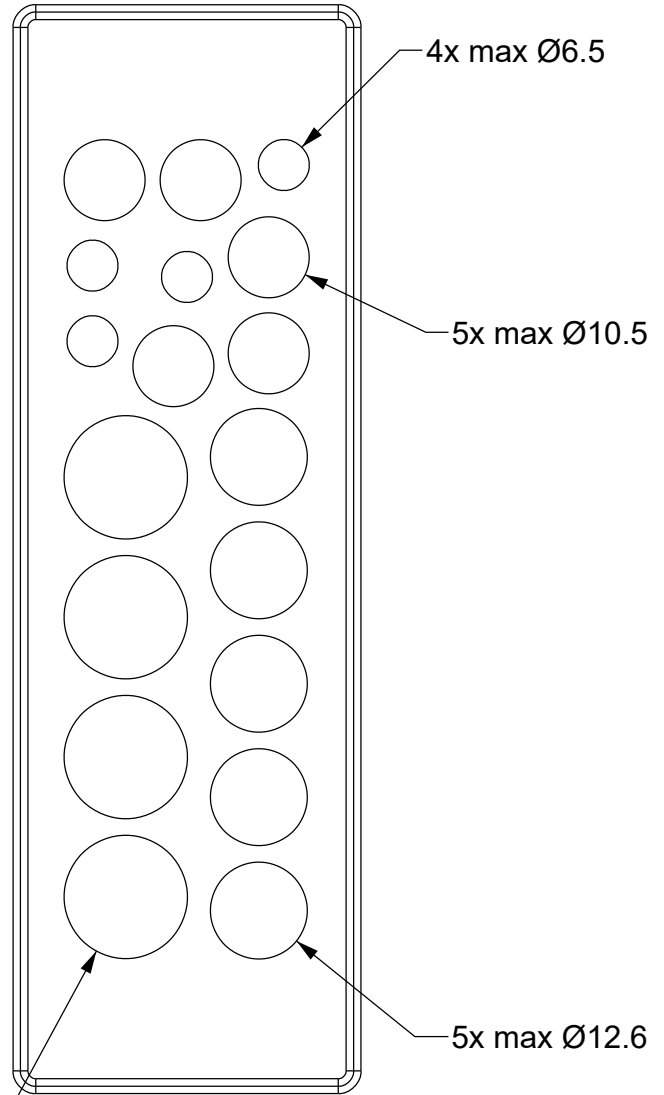
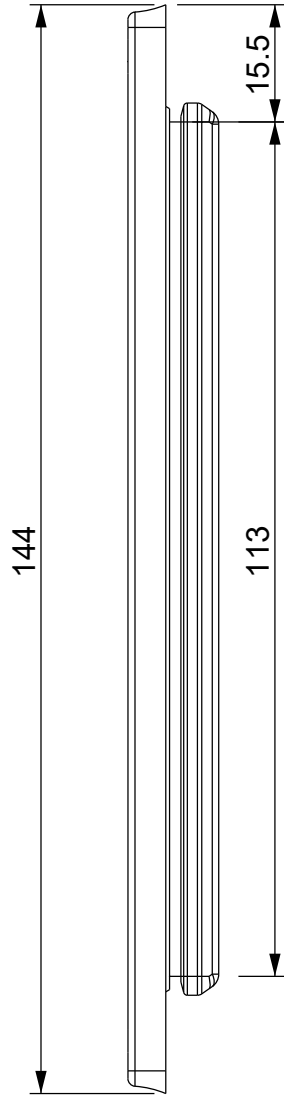
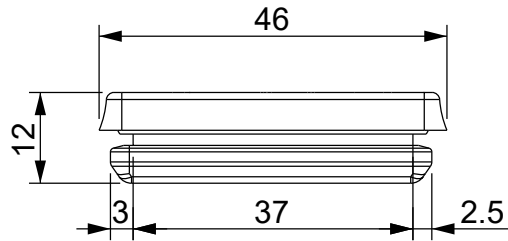
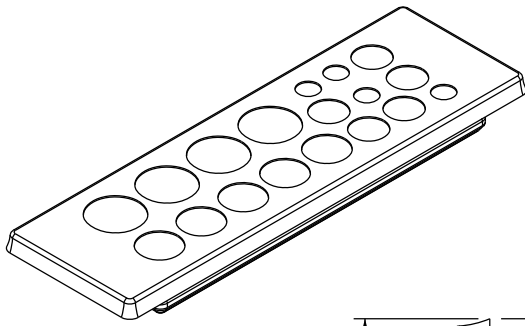

4x max Ø16.1

Versione colore NERO:
DES PM 24/18B 1732053419

Spessore parete: 1.5 - 2.5 mm

Infiammabilità: UL94-V0, autoestinguente
Temperatura: -40°C ... +105°C
Proprietà: senza alogeni, senza siliceni
Materiale: elastomero termoplastico (TPE)

Apertura consigliata:
112 x 36 mm

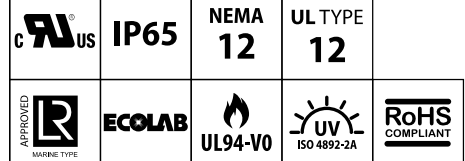
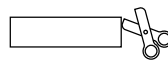

Codice / Code

1732052418

Descrizione / Description

DES PM 24/18 G

Rev.
004

Materiale / Material

TPE

Colore / Color

Grigio

Peso / Weight (g)

-

Unità di misura / Measure units

mm

Formato / Format

A4

Scala / Scale

1:1



www.detasultra.com

Data / Date
10/12/2021

Numero foglio / Sheet number

-

Numero progetto / Project number

-

Disegn. / Drawn

ravezzano@detas.com

Note / Notes

-

QUESTO DISEGNO E LE SUE INFORMAZIONI SONO STRETTAMENTE RISERVATE DI PROPRIETÀ DETAS SPA.
NON UTILIZZARE PER SCOPI DIVERSI DA QUELLI PER CUI SONO STATE FORNITE. DO NOT SCALE DRAWING.

A

B

C

D

A

B

C

D

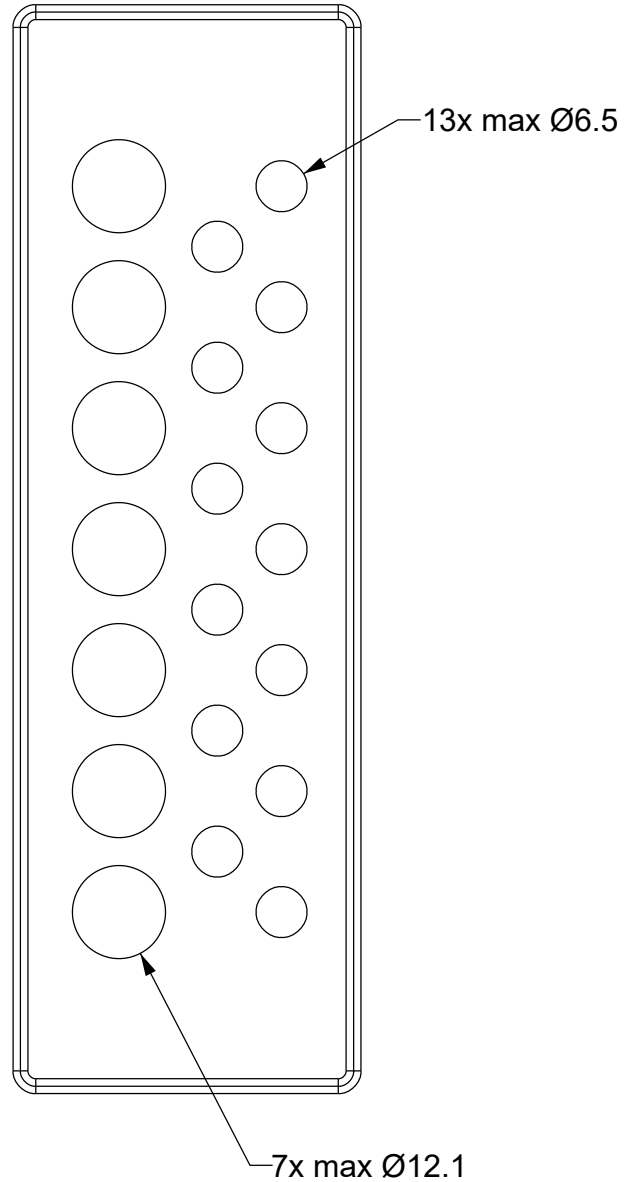
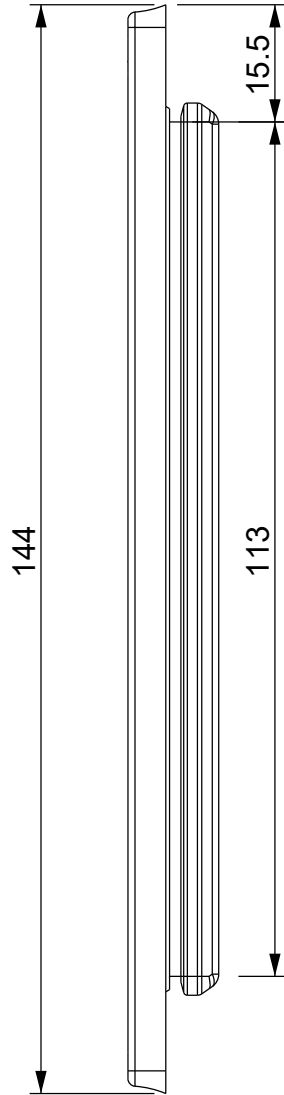
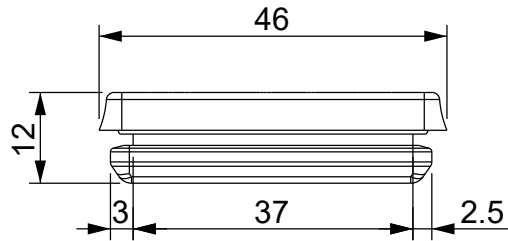
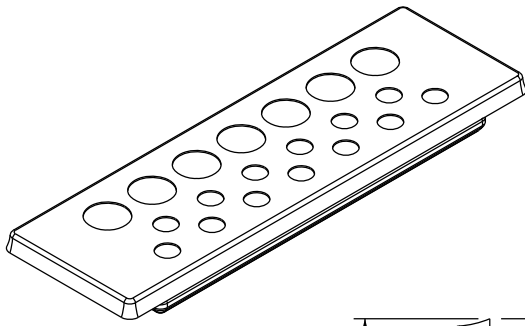

Versione colore NERO:
DES PM 24/20B 1732053421

Spessore parete: 1.5 - 2.5 mm

Infiammabilità: UL94-V0, autoestinguente
Temperatura: -40°C ... +105°C
Proprietà: senza alogeni, senza siliceni
Materiale: elastomero termoplastico (TPE)

Apertura consigliata:
112 x 36 mm

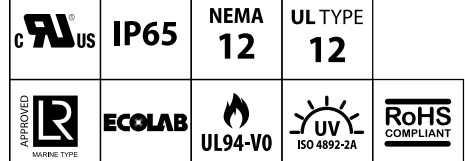
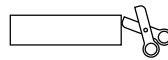

Codice / Code

1732052420

Descrizione / Description

DES PM 24/20 G

Rev.
004

Materiale / Material

TPE

Colore / Color

Grigio

Peso / Weight (g)

-

Unità di misura / Measure units

mm

Formato / Format

A4

Scala / Scale

1:1



www.detasultra.com

Data / Date
10/12/2021

Numero foglio / Sheet number

-

Numero progetto / Project number

-

Disegn. / Drawn

ravezzano@detas.com

Note / Notes

-

QUESTO DISEGNO E LE SUE INFORMAZIONI SONO STRETTAMENTE RISERVATE DI PROPRIETA' DETAS SPA.
NON UTILIZZARE PER SCOPI DIVERSI DA QUELLI PER CUI SONO STATE FORNITE. DO NOT SCALE DRAWING.

A

B

C

D

A

B

C

D

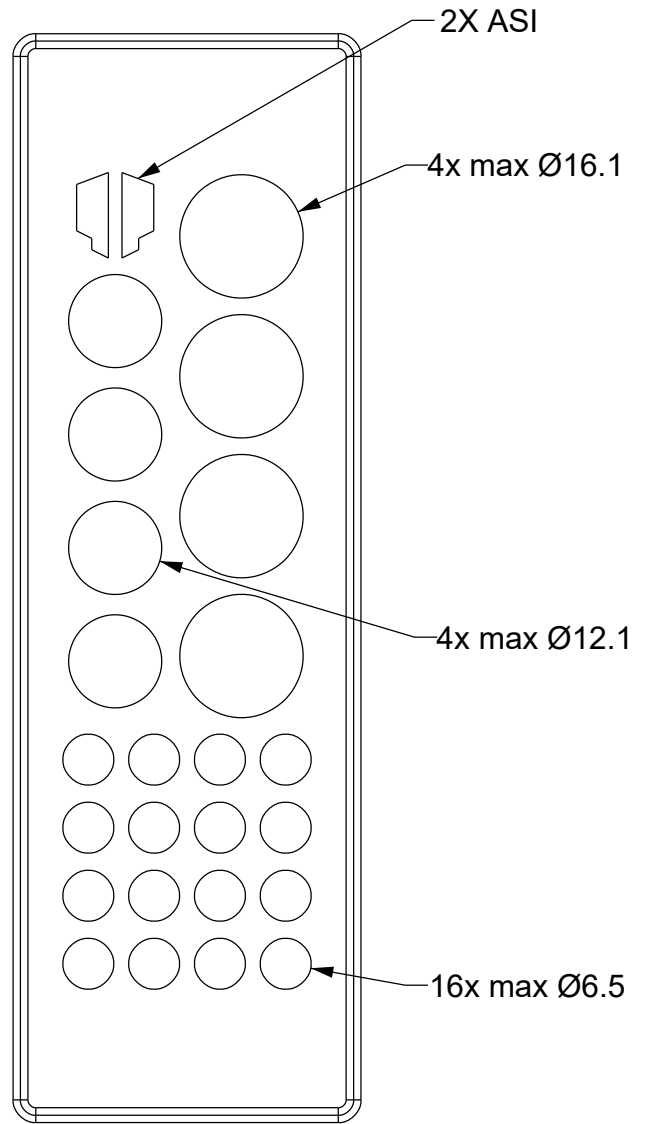
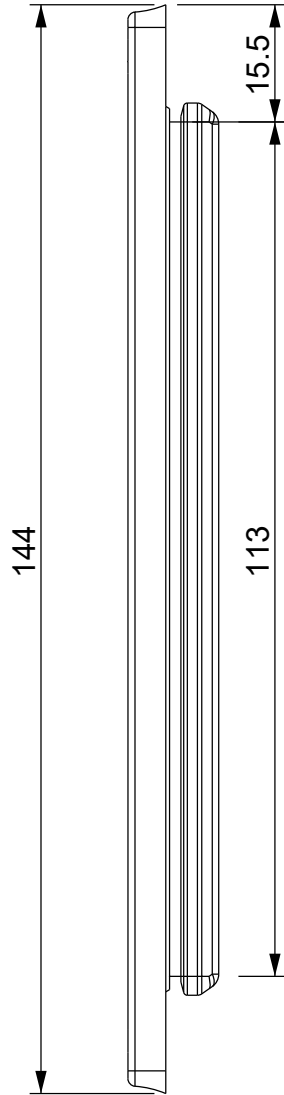
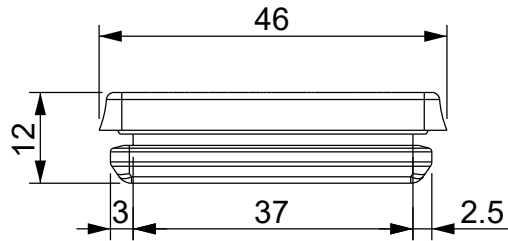
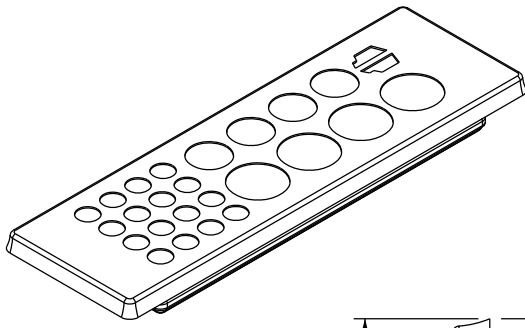

Versione colore NERO:
DES PM 24/26B 1732053427

Spessore parete: 1.5 - 2.5 mm

Infiammabilità: UL94-V0, autoestinguente
Temperatura: -40°C ... +105°C
Proprietà: senza alogeni, senza siliceni
Materiale: elastomero termoplastico (TPE)

Apertura consigliata:
112 x 36 mm

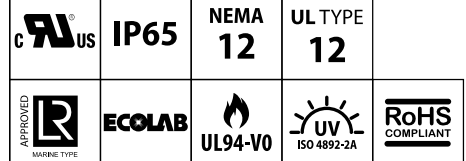
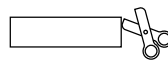

Codice / Code

1732052426

Descrizione / Description

DES PM 24/26 G

Rev.
004

Materiale / Material

TPE

Colore / Color

Grigio

Peso / Weight (g)

-

Unità di misura / Measure units

mm

Formato / Format

A4

Scala / Scale

1:1



Data / Date
10/12/2021

Numero foglio / Sheet number

-

Numero progetto / Project number

-

Disegn. / Drawn

ravezzano@detas.com

Note / Notes

-

QUESTO DISEGNO E LE SUE INFORMAZIONI SONO STRETTAMENTE RISERVATE DI PROPRIETA' DETAS SPA.
NON UTILIZZARE PER SCOPI DIVERSI DA QUELLI PER CUI SONO STATE FORNITE. DO NOT SCALE DRAWING.

A

B

C

D

A

B

C

D

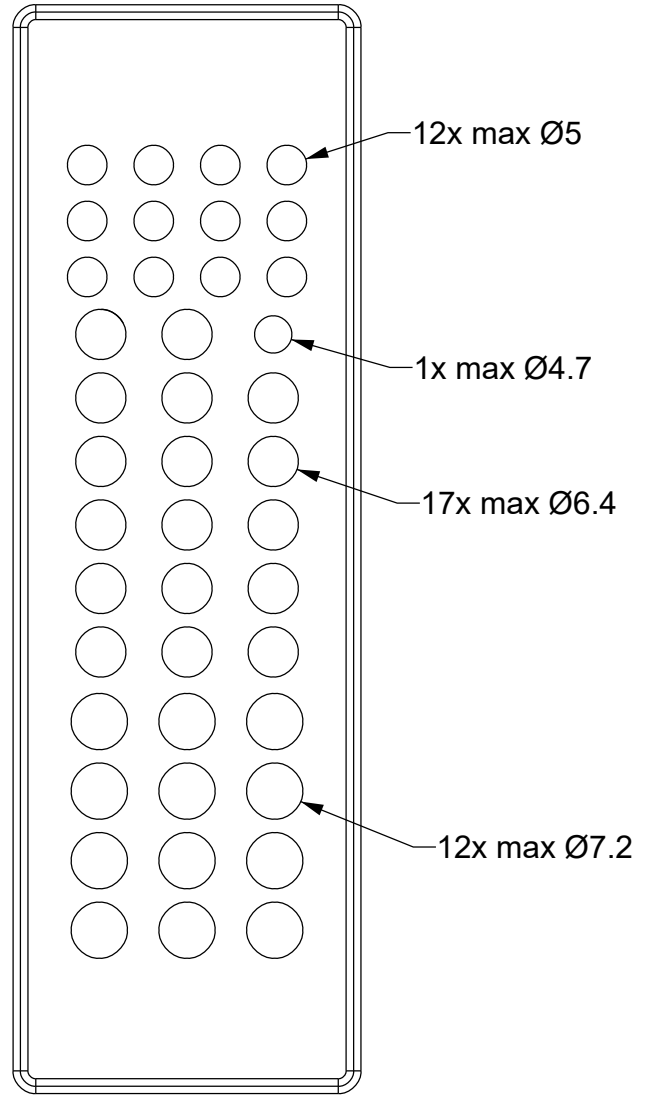
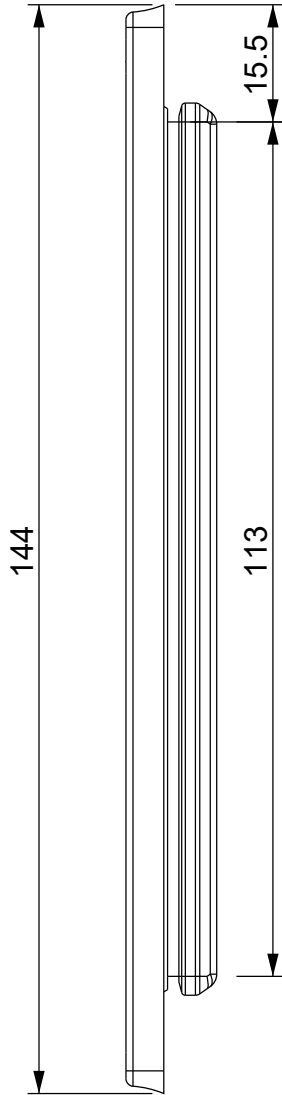
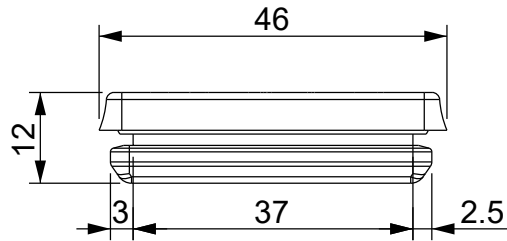
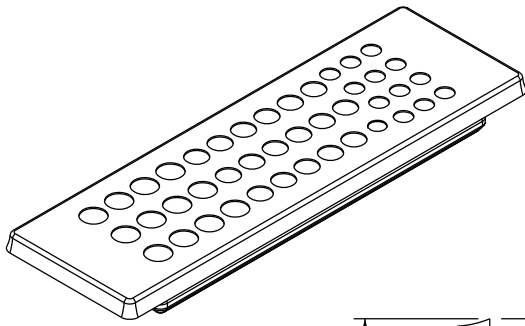

Versione colore NERO:
DES PM 24/42B 1732053443

Spessore parete: 1.5 - 2.5 mm

Infiammabilità: UL94-V0, autoestinguente
Temperatura: -40°C ... +105°C
Proprietà: senza alogeni, senza siliceni
Materiale: elastomero termoplastico (TPE)

Apertura consigliata:
112 x 36 mm

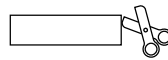

IP65

NEMA
12

UL TYPE
12



ECOLAB



Codice / Code

1732052442

Descrizione / Description

DES PM 24/42 G

Rev.
004

Materiale / Material

TPE

Colore / Color

Grigio

Peso / Weight (g)

-

Unità di misura / Measure units

mm

Formato / Format

A4

Scala / Scale

1:1

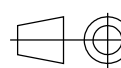

UNI-ISO
2768-mk



www.detasultra.com

Data / Date
10/12/2021

Numero foglio / Sheet number

-

Numero progetto / Project number

-

Disegn. / Drawn

ravezzano@detas.com

Note / Notes

-

QUESTO DISEGNO E LE SUE INFORMAZIONI SONO STRETTAMENTE RISERVATE DI PROPRIETA' DETAS SPA.
NON UTILIZZARE PER SCOPI DIVERSI DA QUELLI PER CUI SONO STATE FORNITE. DO NOT SCALE DRAWING.

A

B

C

D

A

B

C

D

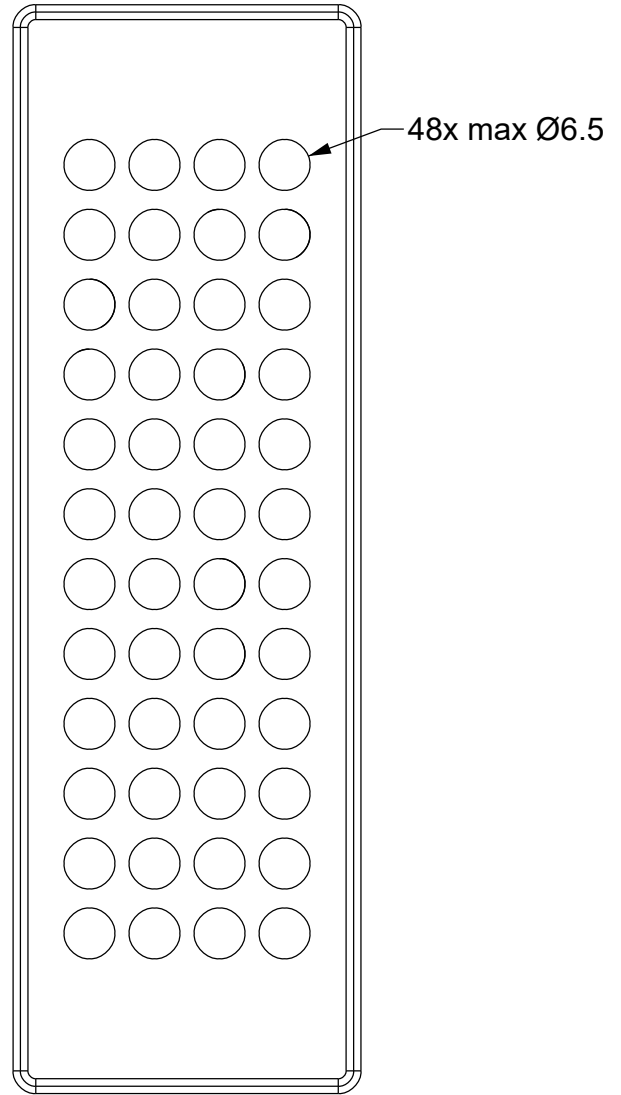
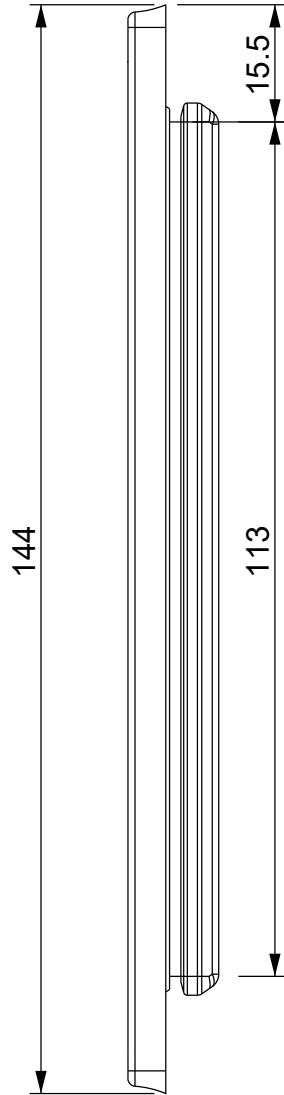
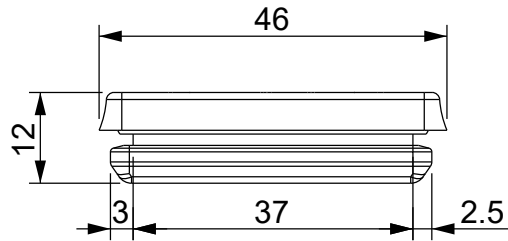
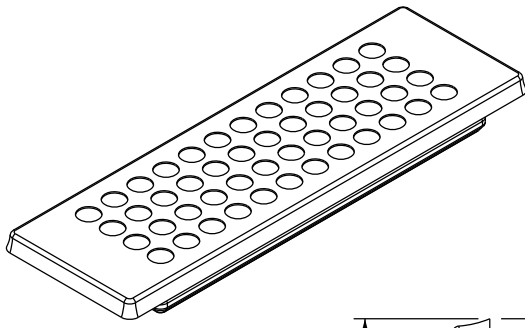

Versione colore NERO:
DES PM 24/48B 1732053449

Spessore parete: 1.5 - 2.5 mm

Infiammabilità: UL94-V0, autoestinguente
Temperatura: -40°C ... +105°C
Proprietà: senza alogeni, senza siliceni
Materiale: elastomero termoplastico (TPE)

Apertura consigliata:
112 x 36 mm

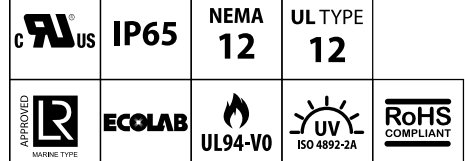
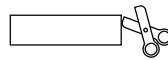

Codice / Code

1732052448

Descrizione / Description

DES PM 24/48 G

Rev.
004

Materiale / Material
TPE

Colore / Color
Grigio

Peso / Weight (g)
-

Unità di misura / Measure units
mm

Formato / Format
A4

Scala / Scale
1:1



Data / Date
10/12/2021

Numero foglio / Sheet number
-

Numero progetto / Project number
-

Disegn. / Drawn
ravezzano@detas.com

Note / Notes
-

QUESTO DISEGNO E LE SUE INFORMAZIONI SONO STRETTAMENTE RISERVATE DI PROPRIETA' DETAS SPA.
NON UTILIZZARE PER SCOPI DIVERSI DA QUELLI PER CUI SONO STATE FORNITE. DO NOT SCALE DRAWING.

A

B

C

D

A

B

C

D

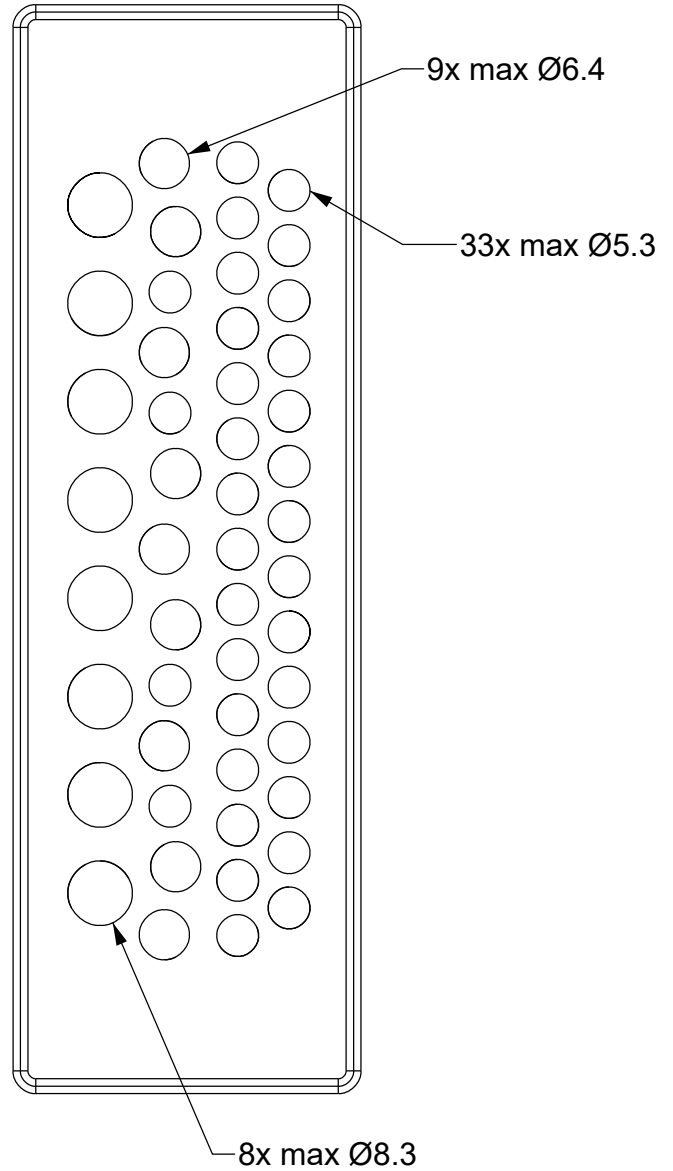
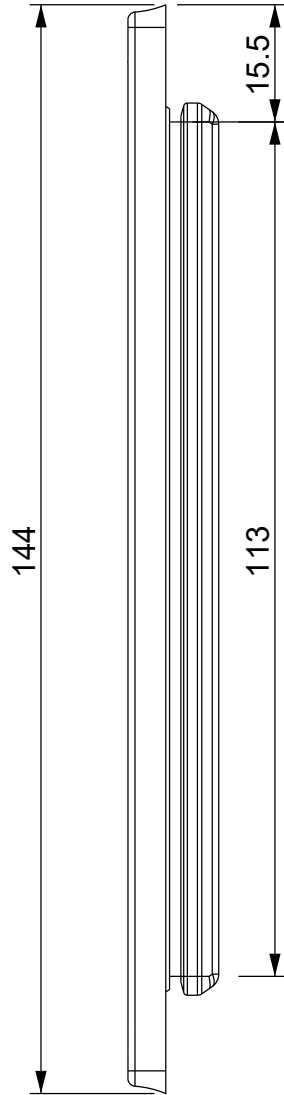
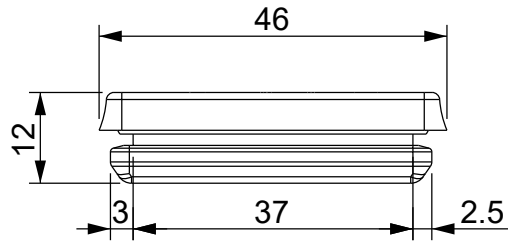
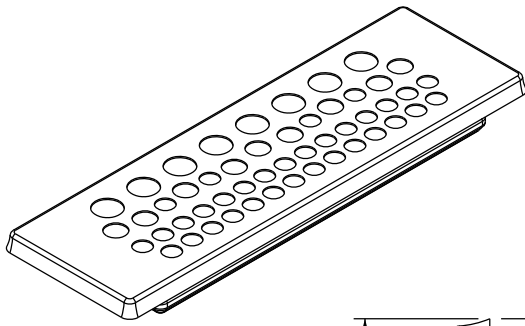

Versione colore NERO:
DES PM 24/50B 1732053451

Spessore parete: 1.5 - 2.5 mm

Infiammabilità: UL94-V0, autoestinguente
Temperatura: -40°C ... +105°C
Proprietà: senza alogeni, senza siliceni
Materiale: elastomero termoplastico (TPE)

Apertura consigliata:
112 x 36 mm

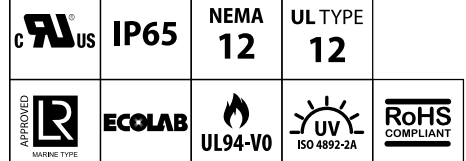
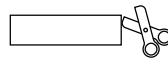

Codice / Code

1732052450

Descrizione / Description

DES PM 24/50 G

Rev.
004

Materiale / Material

TPE

Colore / Color

Grigio

Peso / Weight (g)

-

Unità di misura / Measure units

mm

Formato / Format

A4

Scala / Scale

1:1



Data / Date
10/12/2021

Numero foglio / Sheet number

-

Numero progetto / Project number

-

Disegn. / Drawn
ravezzano@detas.com

Note / Notes

-

QUESTO DISEGNO E LE SUE INFORMAZIONI SONO STRETTAMENTE RISERVATE DI PROPRIETÀ DETAS SPA. NON UTILIZZARE PER SCOPI DIVERSI DA QUELLI PER CUI SONO STATE FORNITE. DO NOT SCALE DRAWING.

A

B

C

D