

A

B

C

D

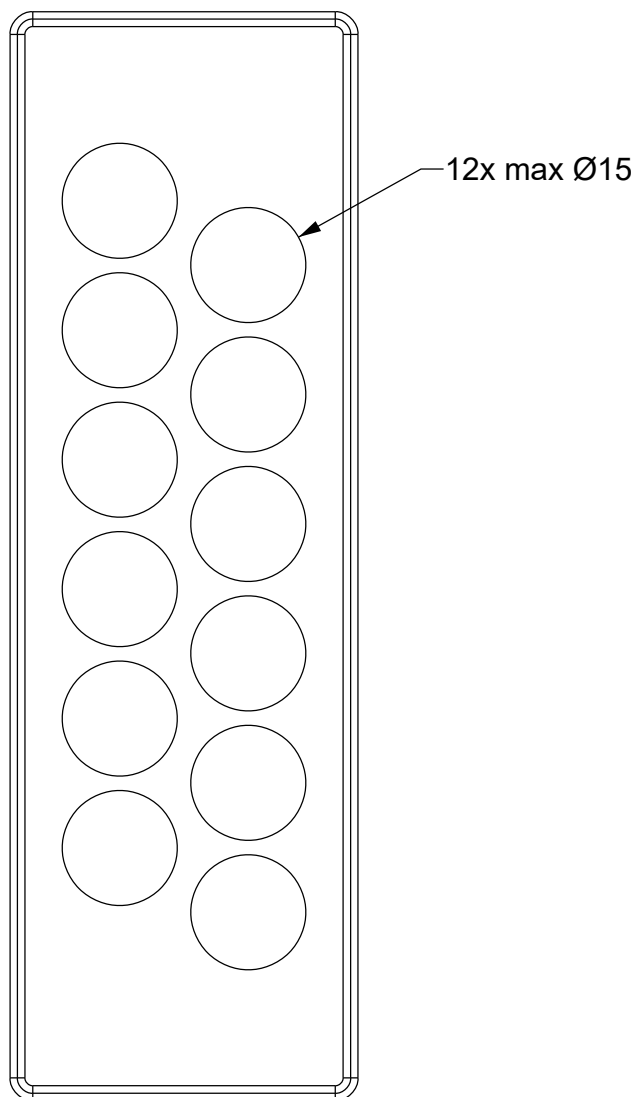
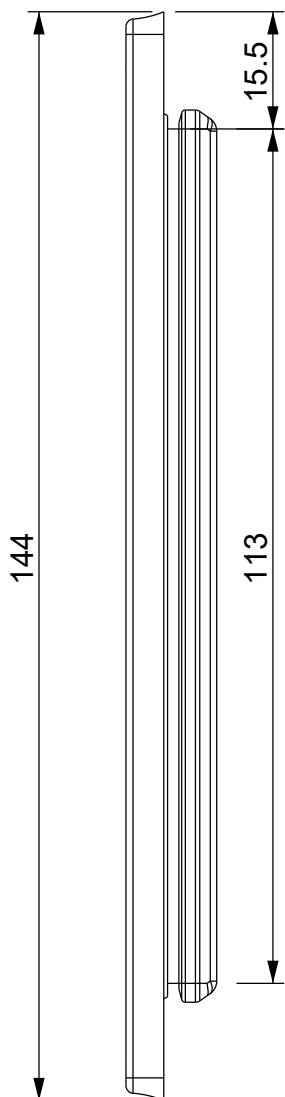
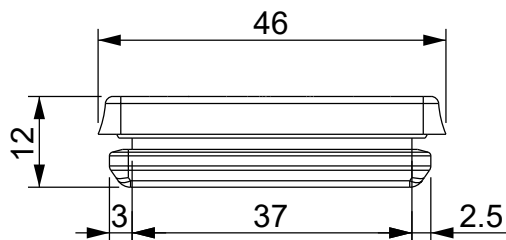
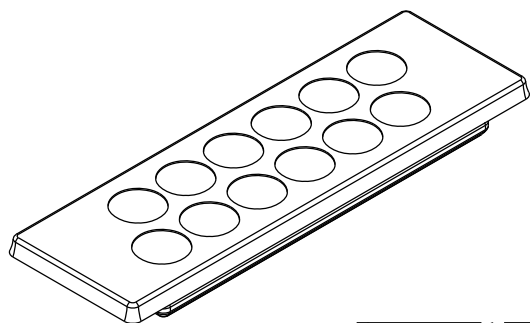

BLACK color version:
DES PM 24/12B 1732053413

Wall thickness: 1.5 - 2.5 mm

Flammability: UL94-V0, self-extinguishing
Temperature: -40°C ... +105°C
Properties: halogen-free, silicone-free
Material: thermoplastic elastomer (TPE)

Recommended cut-out:
112 x 36 mm

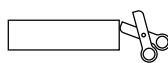

IP65

NEMA
12

UL TYPE
12



ECOLAB



UL94-V0



UV
ISO 4892-2A



RoHS
COMPLIANT

Codice / Code

1732052412

Descrizione / Description

DES PM 24/12 G

Rev.
004

Materiale / Material

TPE

Colore / Color

Grey

Peso / Weight (g)

-

Unità di misura / Measure units

mm

Formato / Format

A4

Scala / Scale

1:1

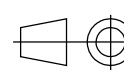

UNI-ISO
2768-mk



Data / Date
10/12/2021

Numero foglio / Sheet number

-

Numero progetto / Project number

-

Disegn. / Drawn
ravezzano@detas.com

Note / Notes

-

QUESTO DISEGNO E LE SUE INFORMAZIONI SONO STRETTAMENTE RISERVATE DI PROPRIETA' DETAS SPA.
NON UTILIZZARE PER SCOPI DIVERSI DA QUELLI PER CUI SONO STATE FORNITE. DO NOT SCALE DRAWING.

A

B

C

D

A

B

C

D

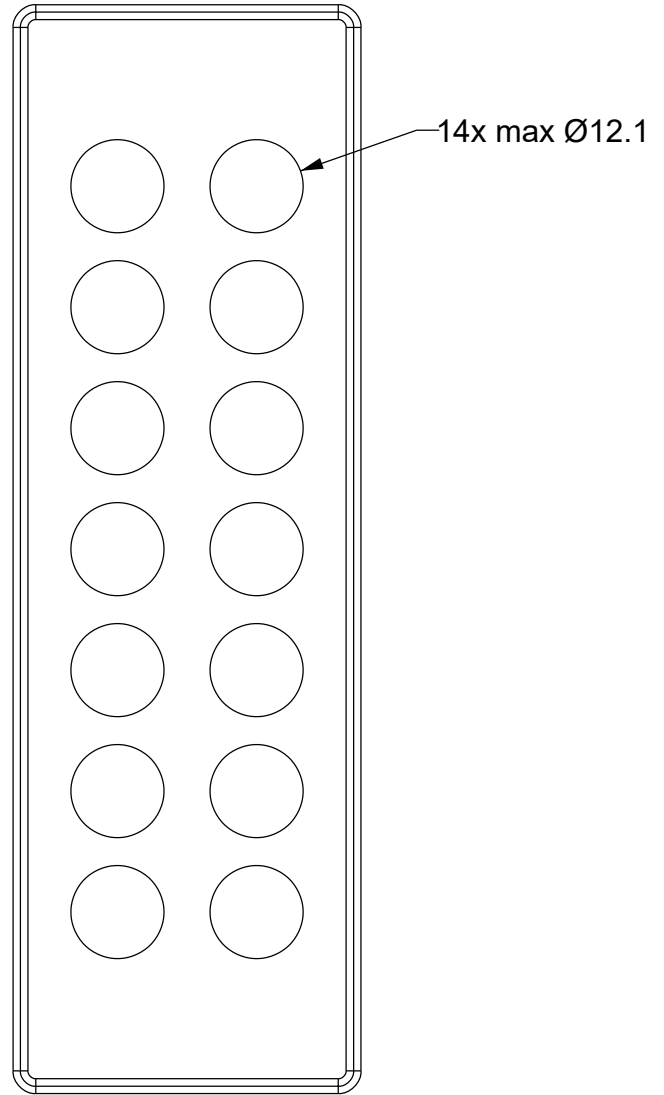
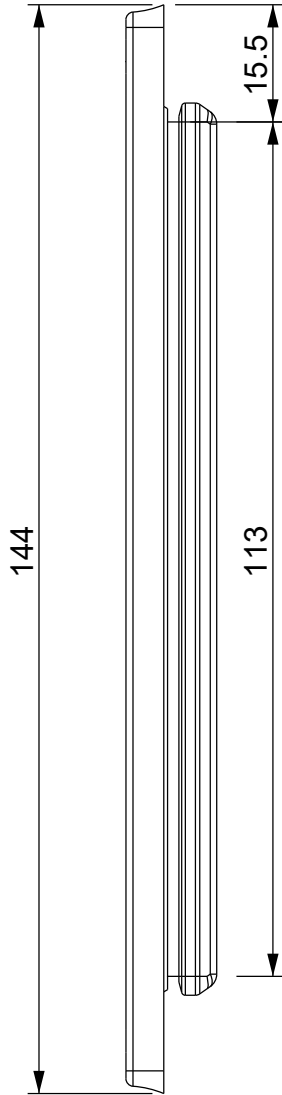
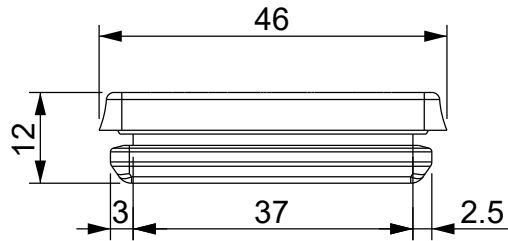
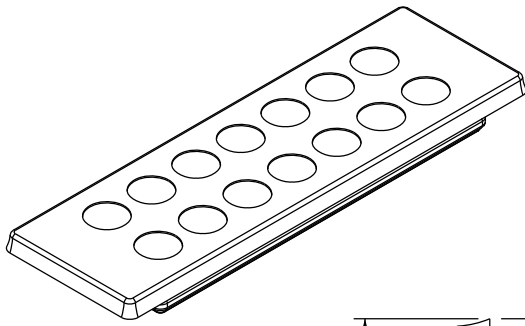

BLACK color version:
DES PM 24/14B 1732053415

Wall thickness: 1.5 - 2.5 mm

Flammability: UL94-V0, self-extinguishing
Temperature: -40°C ... +105°C
Properties: halogen-free, silicone-free
Material: thermoplastic elastomer (TPE)

Recommended cut-out:
112 x 36 mm

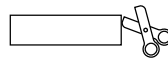

IP65

NEMA
12

UL TYPE
12



UL94-V0



ISO 4892-2A



Codice / Code

1732052414

Descrizione / Description

DES PM 24/14 G

Rev.
004

Materiale / Material

TPE

Colore / Color

Grey

Peso / Weight (g)

-

Unità di misura / Measure units

mm

Formato / Format

A4

Scala / Scale

1:1

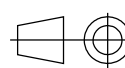

UNI-ISO
2768-mk



www.detasultra.com

Data / Date
10/12/2021

Numero foglio / Sheet number

-

Numero progetto / Project number

-

Disegn. / Drawn

ravezzano@detas.com

Note / Notes

-

QUESTO DISEGNO E LE SUE INFORMAZIONI SONO STRETTAMENTE RISERVATE DI PROPRIETA' DETAS SPA.
NON UTILIZZARE PER SCOPI DIVERSI DA QUELLI PER CUI SONO STATE FORNITE. DO NOT SCALE DRAWING.

A

B

C

D

A

B

C

D

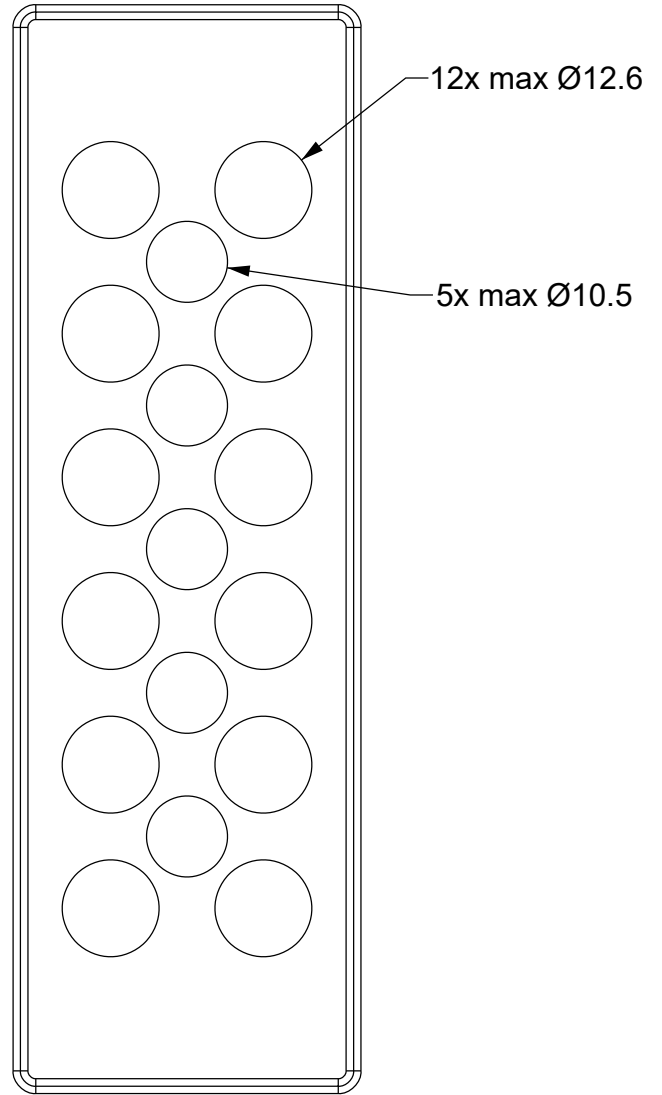
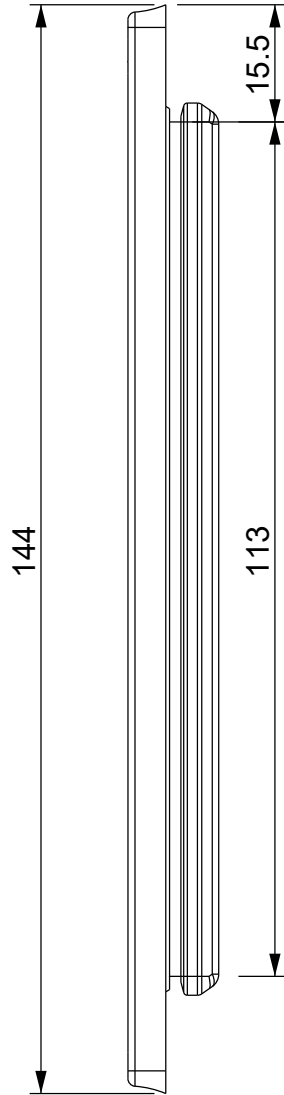
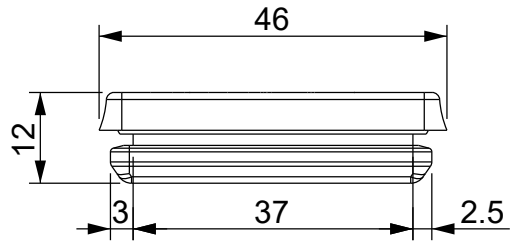
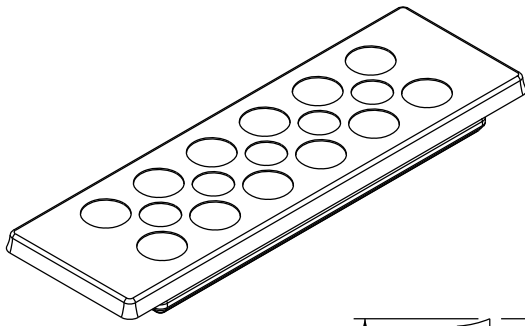

BLACK color version:
DES PM 24/17B 1732053418

Wall thickness: 1.5 - 2.5 mm

Flammability: UL94-V0, self-extinguishing
Temperature: -40°C ... +105°C
Properties: halogen-free, silicone-free
Material: thermoplastic elastomer (TPE)

Recommended cut-out:
112 x 36 mm

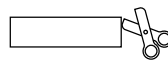

IP65

NEMA
12

UL TYPE
12



ECOLAB



UL94-V0



UV
ISO 4892-2A



RoHS
COMPLIANT

Codice / Code

1732052417

Descrizione / Description

DES PM 24/17 G

Rev.
004

Materiale / Material

TPE

Colore / Color

Grey

Peso / Weight (g)

-

Unità di misura / Measure units

mm

Formato / Format

A4

Scala / Scale

1:1

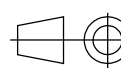

UNI-ISO
2768-mk



Data / Date
10/12/2021

Numero foglio / Sheet number

-

Numero progetto / Project number

-

Disegn. / Drawn
ravezzano@detas.com

Note / Notes

-

QUESTO DISEGNO E LE SUE INFORMAZIONI SONO STRETTAMENTE RISERVATE DI PROPRIETA' DETAS SPA.
NON UTILIZZARE PER SCOPI DIVERSI DA QUELLI PER CUI SONO STATE FORNITE. DO NOT SCALE DRAWING.

A

B

C

D

A

B

C

D

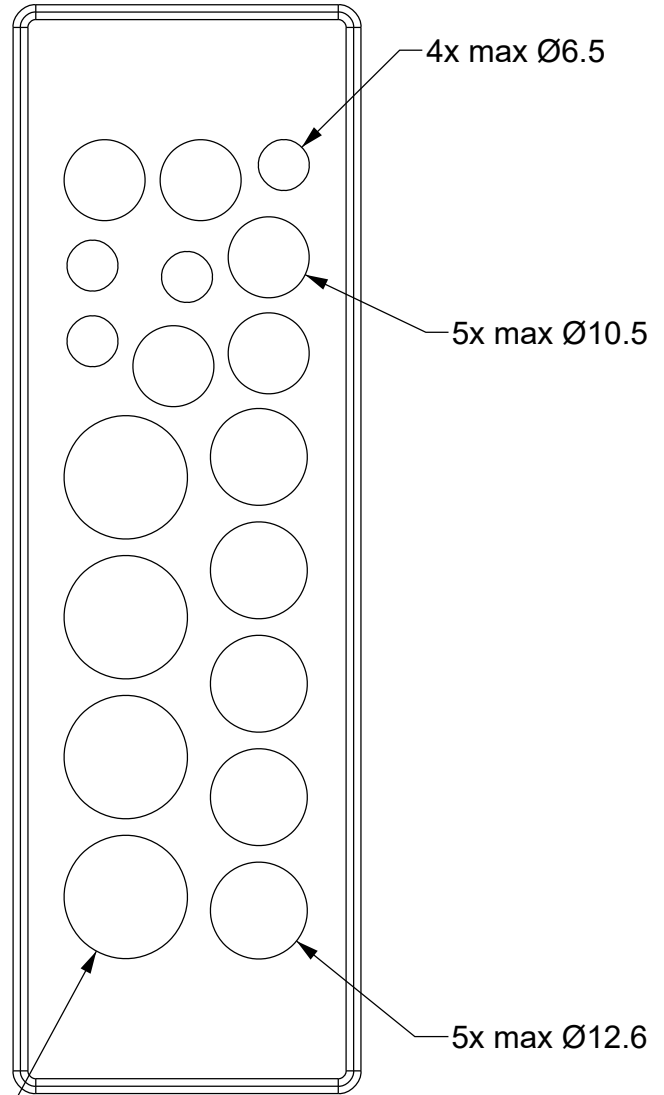
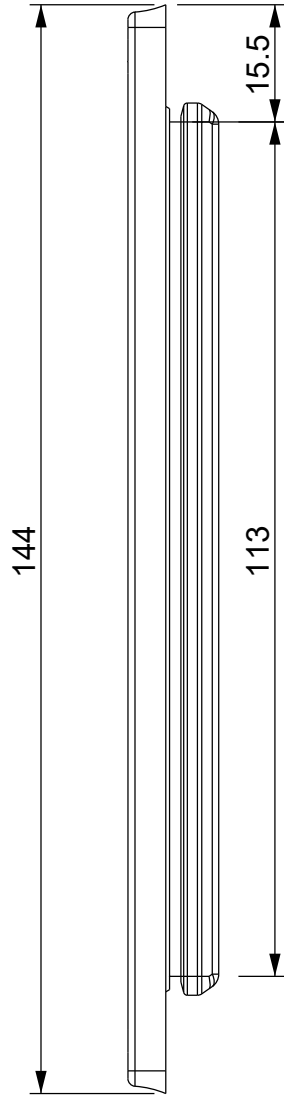
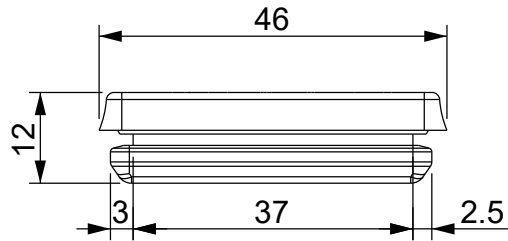
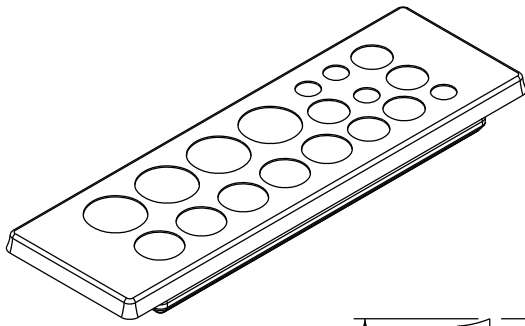

4x max Ø16.1

BLACK color version:
DES PM 24/18B 1732053419

Wall thickness: 1.5 - 2.5 mm

Flammability: UL94-V0, self-extinguishing
Temperature: -40°C ... +105°C
Properties: halogen-free, silicone-free
Material: thermoplastic elastomer (TPE)

Recommended cut-out:
112 x 36 mm

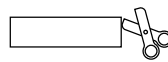

IP65

NEMA
12UL TYPE
12

ECOLAB



Codice / Code

1732052418

Descrizione / Description

DES PM 24/18 G

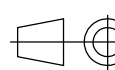
Rev.
004Materiale / Material
TPEColore / Color
GreyPeso / Weight (g)
-Unità di misura / Measure units
mmFormato / Format
A4Scala / Scale
1:1UNI-ISO
2768-mkData / Date
10/12/2021Numero foglio / Sheet number
-Numero progetto / Project number
-Disegn. / Drawn
ravezzano@detas.comNote / Notes
-

QUESTO DISEGNO E LE SUE INFORMAZIONI SONO STRETTAMENTE RISERVATE DI PROPRIETA' DETAS SPA.
NON UTILIZZARE PER SCOPI DIVERSI DA QUELLI PER CUI SONO STATE FORNITE. DO NOT SCALE DRAWING.

A

B

C

D

A

B

C

D

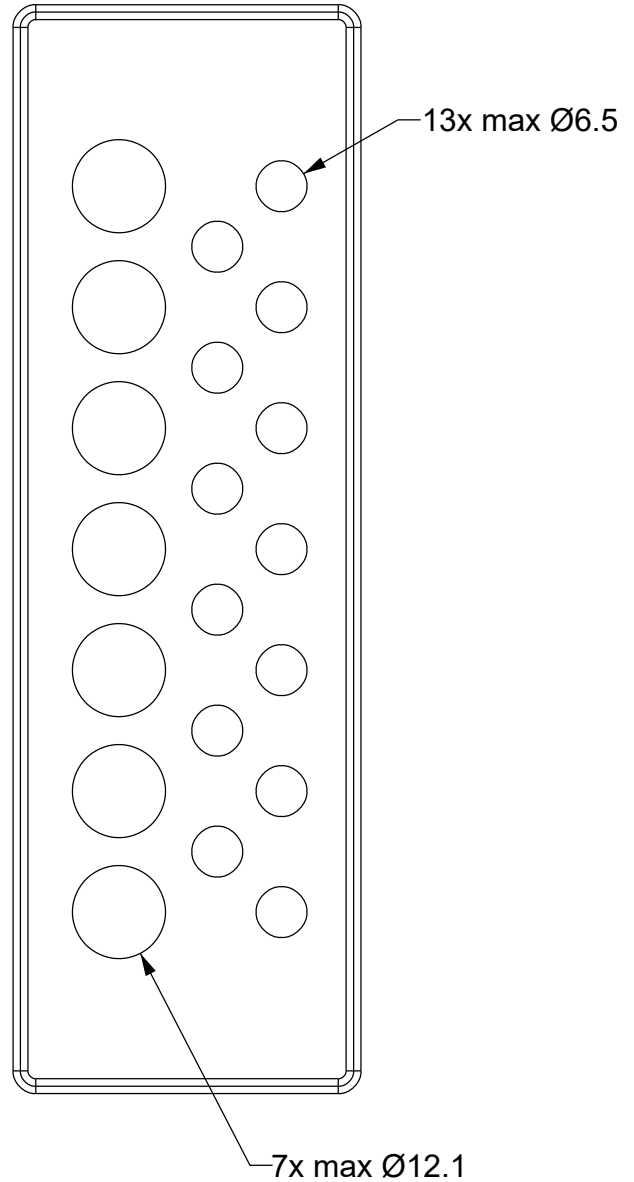
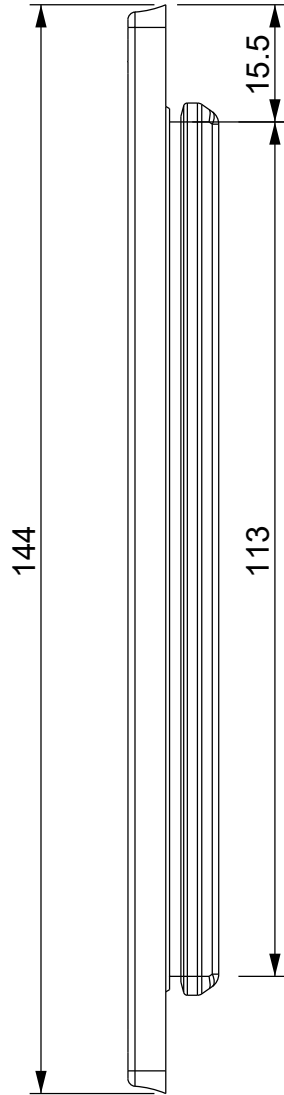
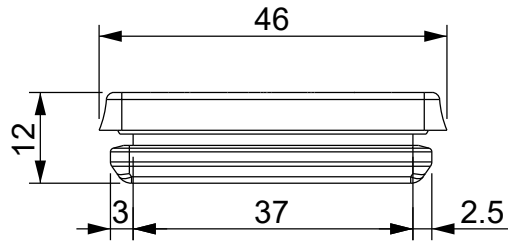
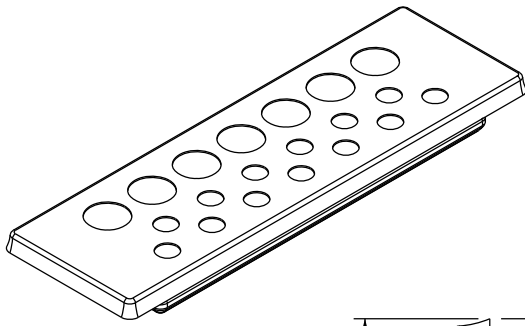

BLACK color version:
DES PM 24/20B 1732053421

Wall thickness: 1.5 - 2.5 mm

Flammability: UL94-V0, self-extinguishing
Temperature: -40°C ... +105°C
Properties: halogen-free, silicone-free
Material: thermoplastic elastomer (TPE)

Recommended cut-out:
112 x 36 mm

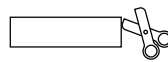

IP65

NEMA
12

UL TYPE
12



UL94-V0



ISO 4892-2A



Codice / Code

1732052420

Descrizione / Description

DES PM 24/20 G

Rev.
004

Materiale / Material

TPE

Colore / Color

Grey

Peso / Weight (g)

-

Unità di misura / Measure units

mm

Formato / Format

A4

Scala / Scale

1:1

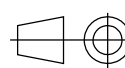

UNI-ISO
2768-mk



Data / Date
10/12/2021

Numero foglio / Sheet number

-

Numero progetto / Project number

-

Disegn. / Drawn
ravezzano@detas.com

Note / Notes

-

QUESTO DISEGNO E LE SUE INFORMAZIONI SONO STRETTAMENTE RISERVATE DI PROPRIETA' DETAS SPA.
NON UTILIZZARE PER SCOPI DIVERSI DA QUELLI PER CUI SONO STATE FORNITE. DO NOT SCALE DRAWING.

A

B

C

D

A

B

C

D

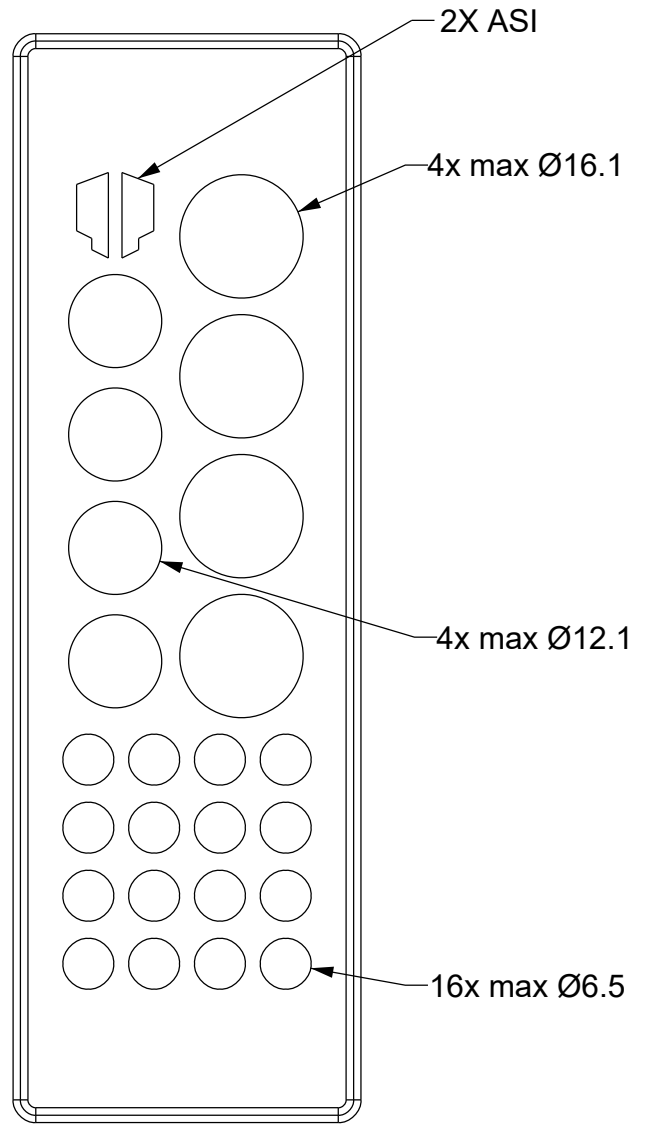
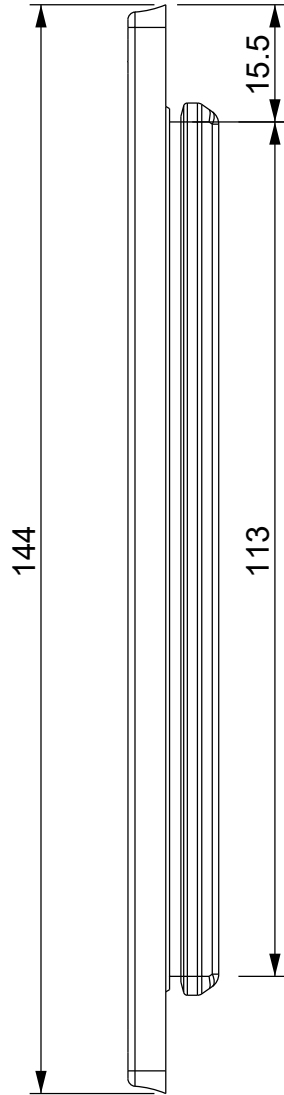
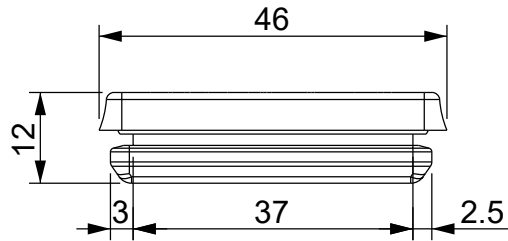
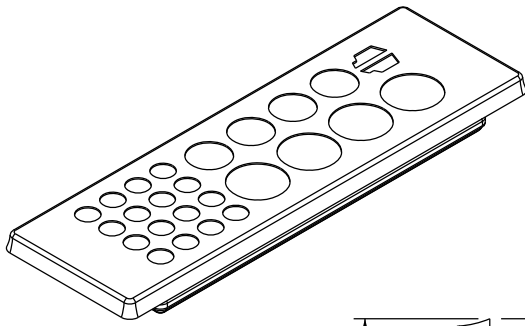

BLACK color version:
DES PM 24/26B 1732053427

Wall thickness: 1.5 - 2.5 mm

Flammability: UL94-V0, self-extinguishing
Temperature: -40°C ... +105°C
Properties: halogen-free, silicone-free
Material: thermoplastic elastomer (TPE)

Recommended cut-out:
112 x 36 mm

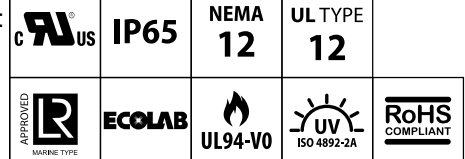
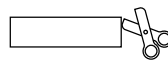

Codice / Code

1732052426

Descrizione / Description

DES PM 24/26 G

Rev.
004

Materiale / Material
TPE

Colore / Color
Grey

Peso / Weight (g)
-

Unità di misura / Measure units
mm

Formato / Format
A4

Scala / Scale
1:1



Data / Date
10/12/2021

Numero foglio / Sheet number
-

Numero progetto / Project number
-

Disegn. / Drawn
ravezzano@detas.com

Note / Notes
-

QUESTO DISEGNO E LE SUE INFORMAZIONI SONO STRETTAMENTE RISERVATE DI PROPRIETA' DETAS SPA.
NON UTILIZZARE PER SCOPI DIVERSI DA QUELLI PER CUI SONO STATE FORNITE. DO NOT SCALE DRAWING.

A

B

C

D

A

B

C

D

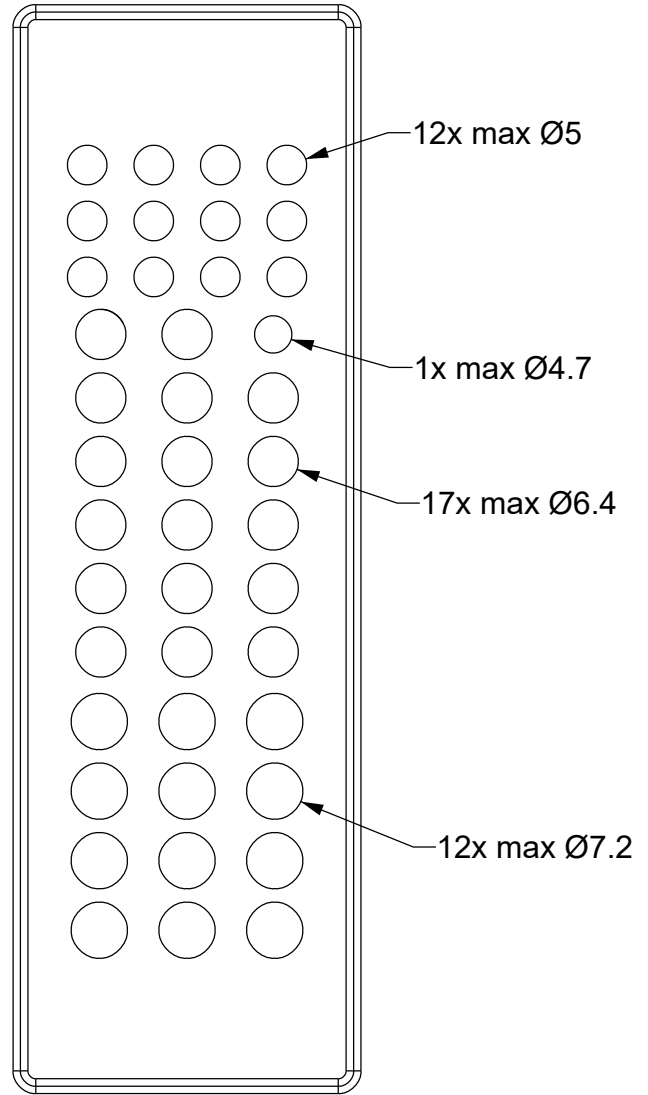
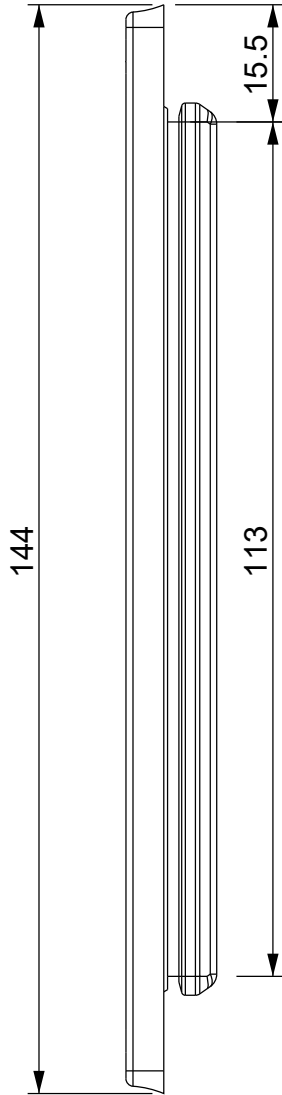
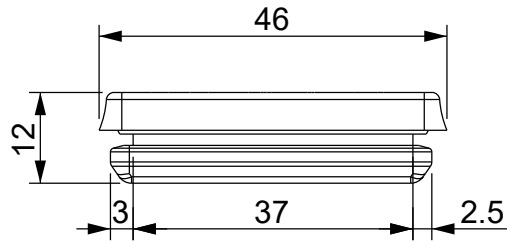
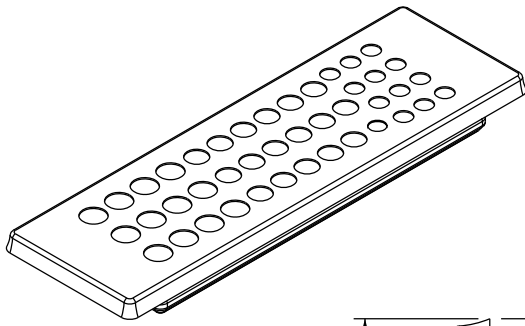

BLACK color version:
DES PM 24/42B 1732053443

Wall thickness: 1.5 - 2.5 mm

Flammability: UL94-V0, self-extinguishing
Temperature: -40°C ... +105°C
Properties: halogen-free, silicone-free
Material: thermoplastic elastomer (TPE)

Recommended cut-out:
112 x 36 mm

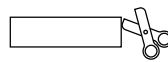

IP65

NEMA
12

UL TYPE
12



ECOLAB



UL94-V0



UV
ISO 4892-2A



RoHS
COMPLIANT

Codice / Code

1732052442

Descrizione / Description

DES PM 24/42 G

Rev.
004

Materiale / Material

TPE

Colore / Color

Grey

Peso / Weight (g)

-

Unità di misura / Measure units

mm

Formato / Format

A4

Scala / Scale

1:1

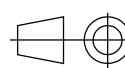

UNI-ISO
2768-mk



Data / Date
10/12/2021

Numero foglio / Sheet number

-

Numero progetto / Project number

-

Disegn. / Drawn
ravezzano@detas.com

Note / Notes

-

QUESTO DISEGNO E LE SUE INFORMAZIONI SONO STRETTAMENTE RISERVATE DI PROPRIETA' DETAS SPA.
NON UTILIZZARE PER SCOPI DIVERSI DA QUELLI PER CUI SONO STATE FORNITE. DO NOT SCALE DRAWING.

A

B

C

D

A

B

C

D

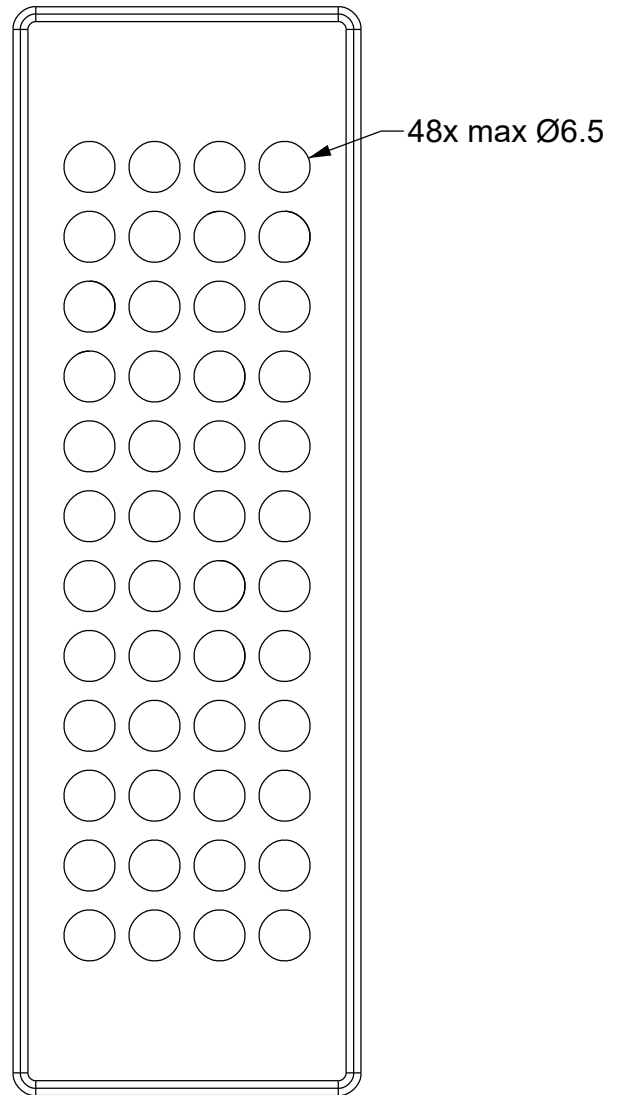
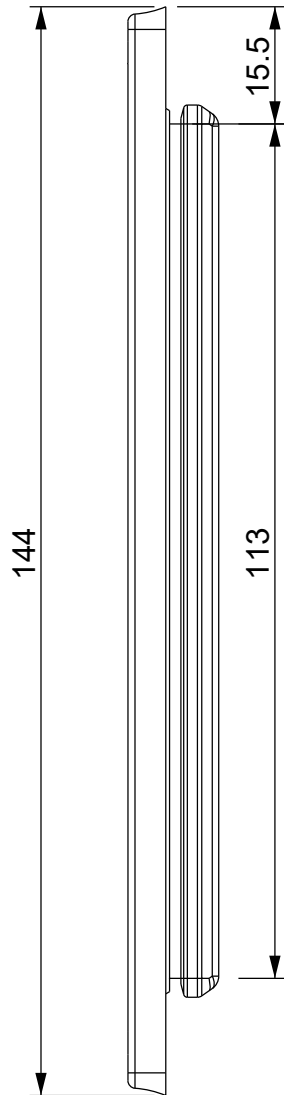
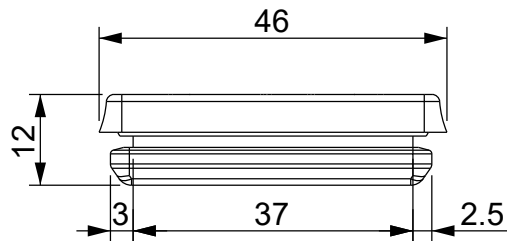
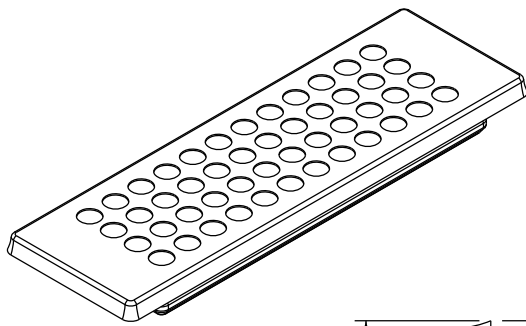

BLACK color version:
DES PM 24/48B 1732053449

Wall thickness: 1.5 - 2.5 mm

Flammability: UL94-V0, self-extinguishing
Temperature: -40°C ... +105°C
Properties: halogen-free, silicone-free
Material: thermoplastic elastomer (TPE)

Recommended cut-out:
112 x 36 mm

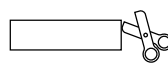

IP65

NEMA
12

UL TYPE
12



ECOLAB



UL94-V0



ISO 4892-2A



RoHS
COMPLIANT

Codice / Code

1732052448

Descrizione / Description

DES PM 24/48 G

Rev.
004

Materiale / Material

TPE

Colore / Color

Grey

Peso / Weight (g)

-

Unità di misura / Measure units

mm

Formato / Format

A4

Scala / Scale

1:1

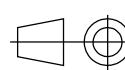

UNI-ISO
2768-mk



Data / Date
10/12/2021

Numero foglio / Sheet number

-

Numero progetto / Project number

-

Disegn. / Drawn
ravezzano@detas.com

Note / Notes

-

QUESTO DISEGNO E LE SUE INFORMAZIONI SONO STRETTAMENTE RISERVATE DI PROPRIETA' DETAS SPA.
NON UTILIZZARE PER SCOPI DIVERSI DA QUELLI PER CUI SONO STATE FORNITE. DO NOT SCALE DRAWING.

A

B

C

D

A

B

C

D

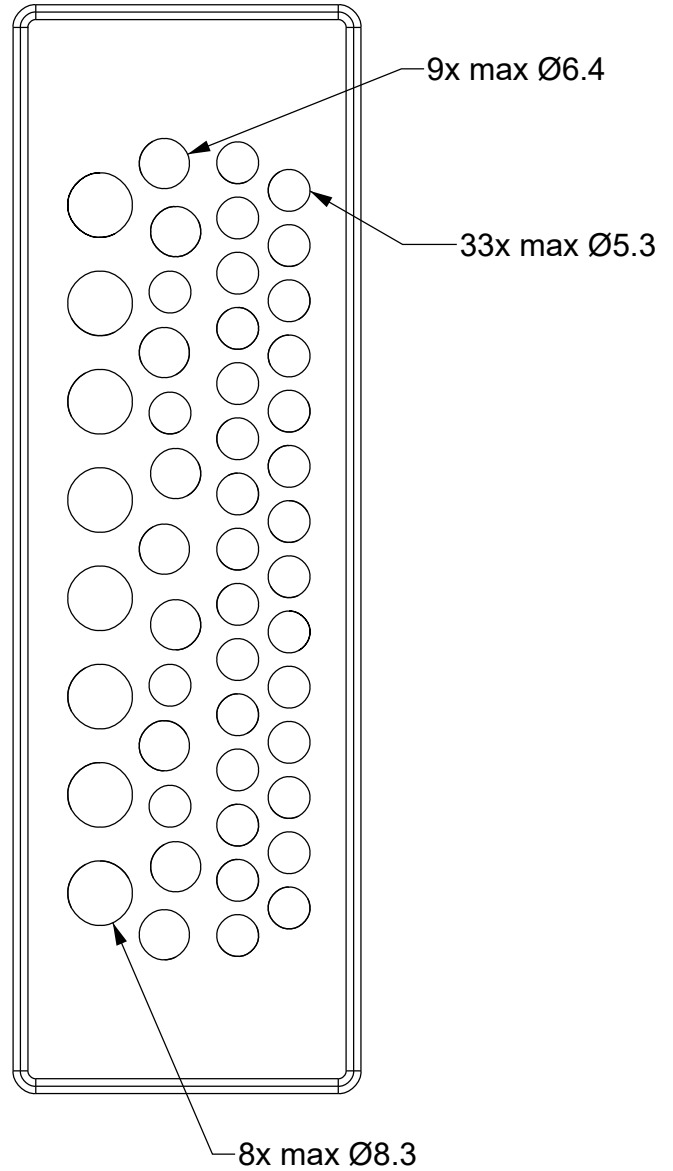
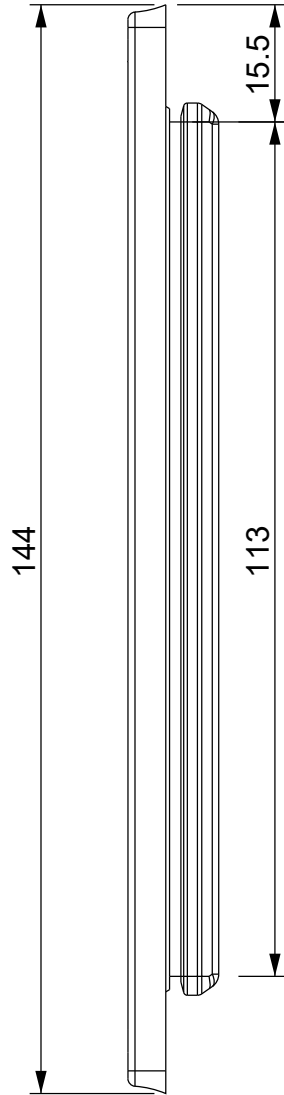
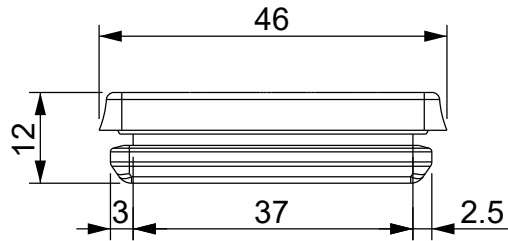
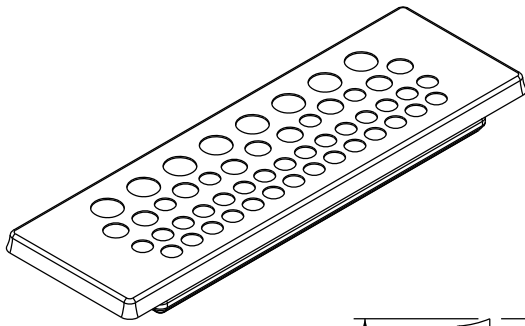

BLACK color version:
DES PM 24/50B 1732053451

Wall thickness: 1.5 - 2.5 mm

Flammability: UL94-V0, self-extinguishing
Temperature: -40°C ... +105°C
Properties: halogen-free, silicone-free
Material: thermoplastic elastomer (TPE)

Recommended cut-out:
112 x 36 mm

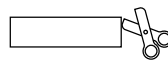

IP65

NEMA
12

UL TYPE
12



ECOLAB



UL94-V0



UV
ISO 4892-2A



RoHS
COMPLIANT

Codice / Code

1732052450

Descrizione / Description

DES PM 24/50 G

Rev.
004

Materiale / Material

TPE

Colore / Color

Grey

Peso / Weight (g)

-

Unità di misura / Measure units

mm

Formato / Format

A4

Scala / Scale

1:1

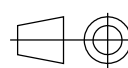

UNI-ISO
2768-mk



Data / Date
10/12/2021

Numero foglio / Sheet number

-

Numero progetto / Project number

-

Disegn. / Drawn
ravezzano@detas.com

Note / Notes

-

QUESTO DISEGNO E LE SUE INFORMAZIONI SONO STRETTAMENTE RISERVATE DI PROPRIETA' DETAS SPA.
NON UTILIZZARE PER SCOPI DIVERSI DA QUELLI PER CUI SONO STATE FORNITE. DO NOT SCALE DRAWING.

A

B

C

D