

A

B

C

D

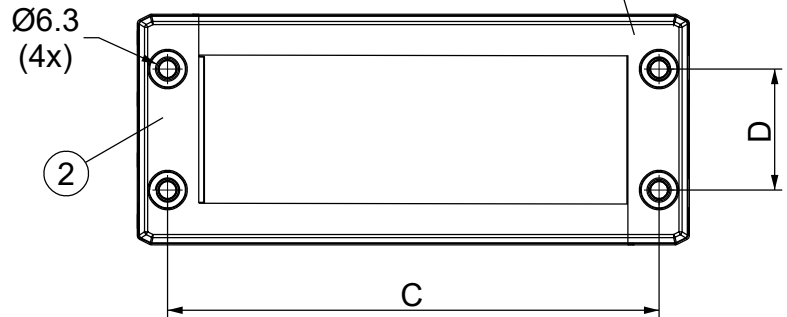
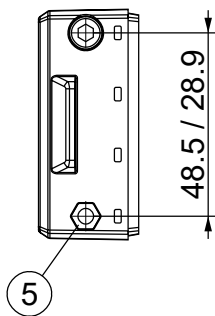
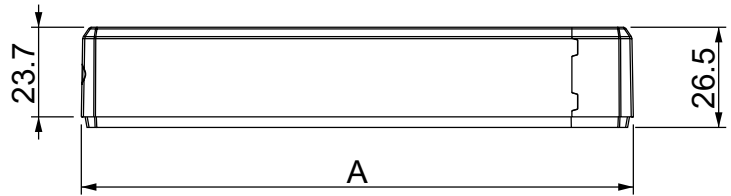
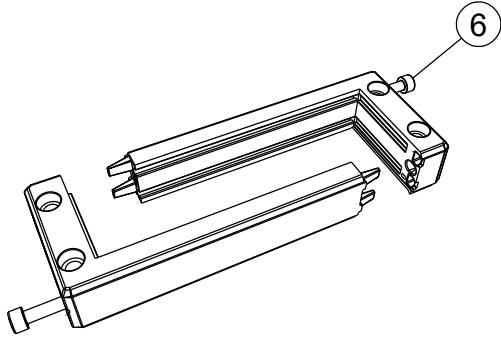
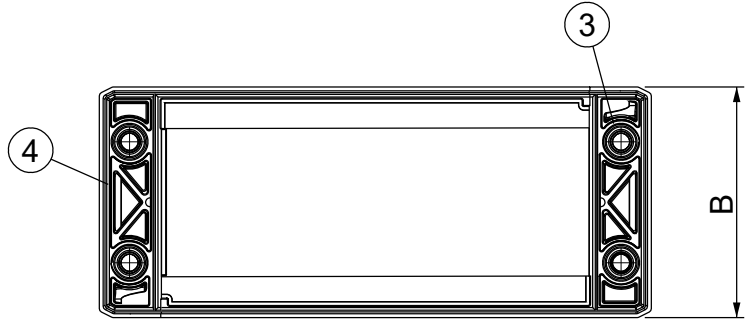
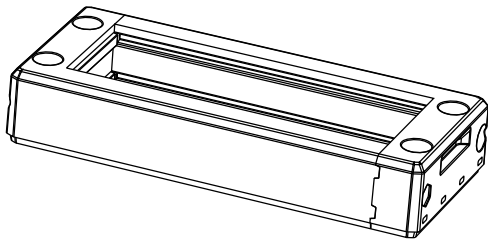

Id	Description	Material	Coating	Q.ty
1	Top	PP + GF	Silver coated copper conductive coating	1
2	Bottom	PP + GF		1
3	Gasket top	TPE		1
4	Gasket bottom	TPE		1
5	Nut (Blck dacromet)	SS304		2
6	Screw Hex M5x0.8	SS304		2

Description	Code	A x B [mm]	C [mm]	D [mm]	Apertura [mm]
DES 24 EMC	1734014024	146 x 61	130	32	112 x 39
DES 16 EMC	1734014016	120 x 61	103	32	86 x 39
DES 10 EMC	1734014010	99 x 61	83	32	63 x 39
DES Q EMC	1734014008	74 x 61	58	32	40 x 39
DES L5 EMC	1734014005	146 x 41,4	130	-	112 x 18
DES L4 EMC	1734014004	120 x 41,4	103	-	86 x 18
DES L3 EMC	1734014003	99 x 41,4	83	-	63 x 18
DES L2 EMC	1734014002	74 x 41,4	58	-	40 x 18

Flammability: UL94-V0, self-extinguishing
Temperature: -40°C ... +100°C
Properties: halogen-free, silicone-free

up to
IP66

NEMA
12, 4X

UL94-V0

ISO 4892-2A

RoHS COMPLIANT

IK10

Codice / Code

see table

Descrizione / Description

DES EMC

Rev.
001

Materiale / Material

see table

Colore / Color

Copper

Peso / Weight (g)

-

Unità di misura / Measure units

mm

Formato / Format

A4

Scala / Scale

1:2

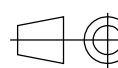

UNI-ISO
2768-MK



Data / Date
18/09/2023

Numero foglio / Sheet number

-

Numero progetto / Project number

-

Disegn. / Drawn
fpozzi@detas.com

Note / Notes

-

QUESTO DISEGNO E LE SUE INFORMAZIONI SONO STRETTAMENTE RISERVATE DI PROPRIETÀ DETAS SPA. NON UTILIZZARE PER SCOPI DIVERSI DA QUELLI PER CUI SONO STATE FORNITE. DO NOT SCALE DRAWING.

A

B

C

D