

A

B

C

D

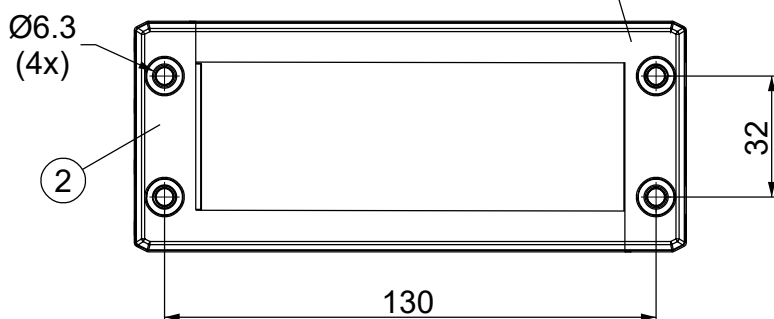
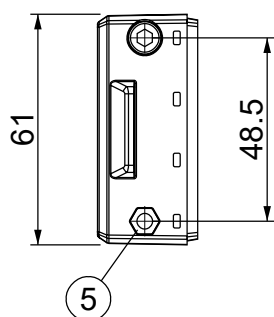
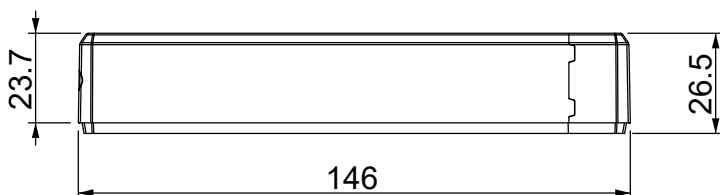
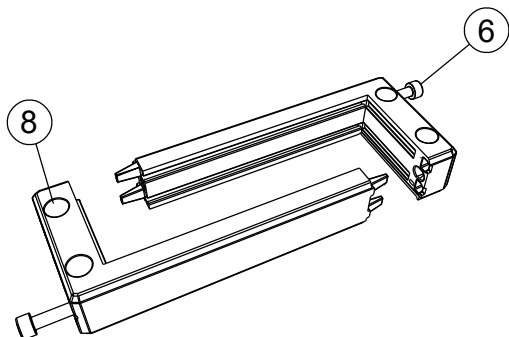
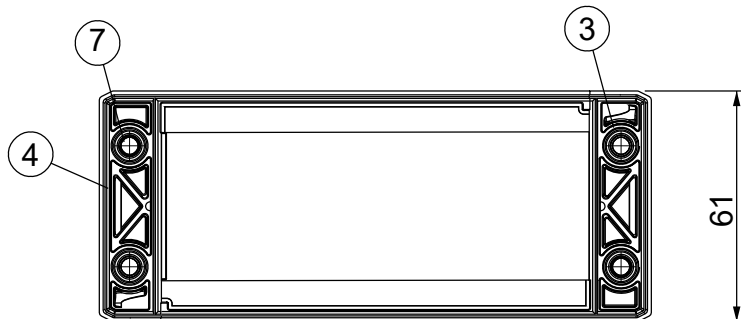
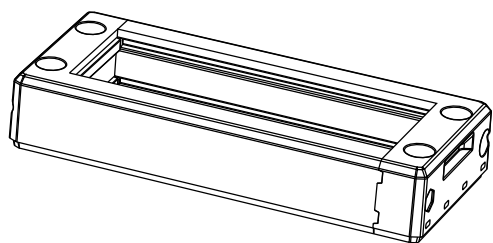

Id	Descrizione	Materiale	Q.tà
1	DES Superiore	PP + GF	1
2	DES Inferiore	PP + GF	1
3	DES guarnizione sup.	TPE	1
4	DES guarnizione inf.	TPE	1
5	Dado (Finit. Black Dacromet)	SS304	2
6	Vite TCEI M5x0.8	SS304	2
7	Inserto M4	Ottone	4
8	Tappo	PP	4

**Infiammabilità:** UL94-V0, autoestinguente

**Temperatura:** -40°C ... +155°C

**Proprietà:** senza alogeni, senza siliconi

Apertura consigliata:

112 x 39 mm

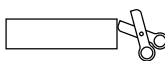

	<b>IP66</b>	<b>NEMA 4X</b>	<b>NEMA 12</b>	<b>HL3</b> EN 45545-2		<b>ECOLAB</b>		<b>UV</b> ISO 4892-2A	<b>RoHS COMPLIANT</b>	<b>IK10</b>			+155 -40 °C	<b>CE</b>
--	-------------	----------------	----------------	--------------------------	--	---------------	--	--------------------------	-----------------------	-------------	--	--	----------------	-----------

Codice / Code

1731410024

Descrizione / Description

DES 24-FT

Rev.

001

Materiale / Material

see table

Colore / Color

Nero

Peso / Weight (g)

156.6

Unità di misura / Measure units

mm

Formato / Format

A4

Scala / Scale

1:2



www.detasultra.com

Data / Date

26/07/2023

Numero foglio / Sheet number

-

Numero progetto / Project number

-

Disegn. / Drawn

Pozzi F.

Note / Notes

-

QUESTO DISEGNO E LE SUE INFORMAZIONI SONO STRETTAMENTE RISERVATE DI PROPRIETÀ DETAS SPA. NON UTILIZZARE PER SCOPI DIVERSI DA QUELLI PER CUI SONO STATE FORNITE. DO NOT SCALE DRAWING.

A

B

C

D